

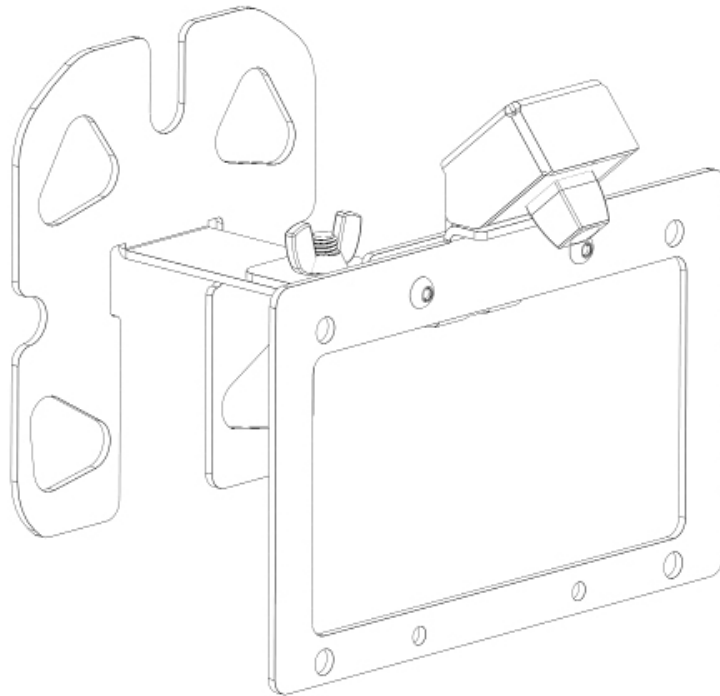

VICTORY 4X4

UNIVERSAL LICENSE PLATE AND CAMERA RELOCATION BRACKET

INSTALL INSTRUCTIONS



Please read the assembly instructions below carefully before attempting to install.

Be sure to check out the install video on the product page, if available.

Thank you for purchasing from Victory 4x4! Checkout our website, victory4x4.com for other great off-road products. Be sure to rate and review our product online. If you have any questions or are missing parts, please don't hesitate to call us at 269-459-8447!

INCLUDED HARDWARE

6x

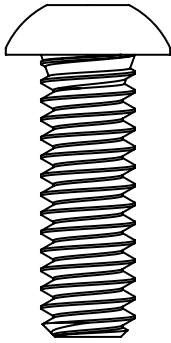

1/4"-20 X 3/4"
Button Head

1x

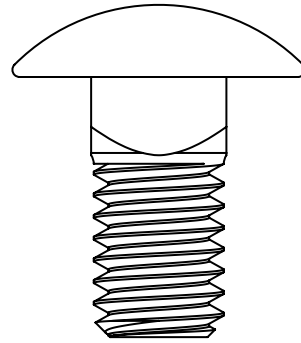

3/8"-16 X 3/4"
Carriage Bolt

6x

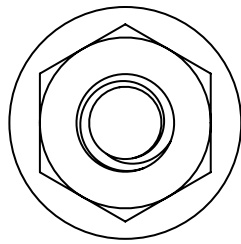

1/4"-20
Serr. Flange Nut

1x

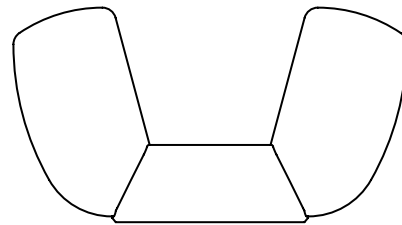

3/8"-16
Wing Nut

INCLUDED PARTS

1x

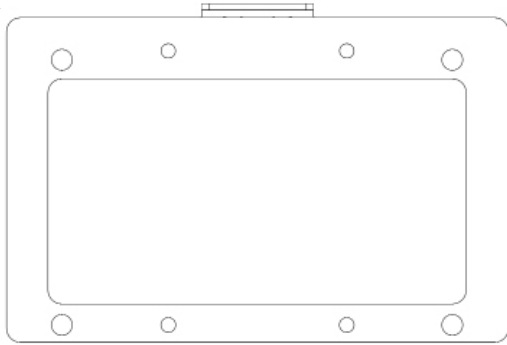

1x

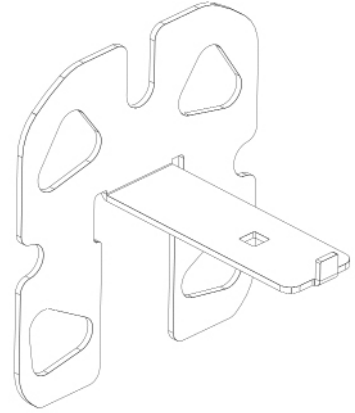

1x

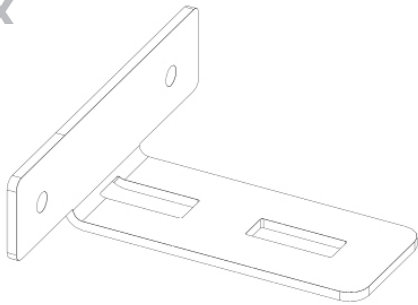

1x

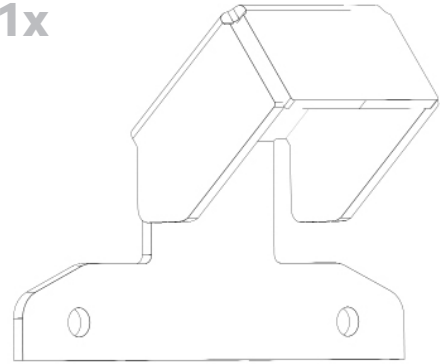

1x

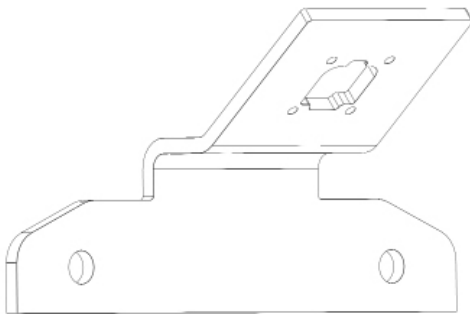

ASSEMBLY

- 1 Assemble the brackets together as shown below using the 1/4"-20 X 3/4" button head bolts and 1/4"-20 serr. flange nuts.

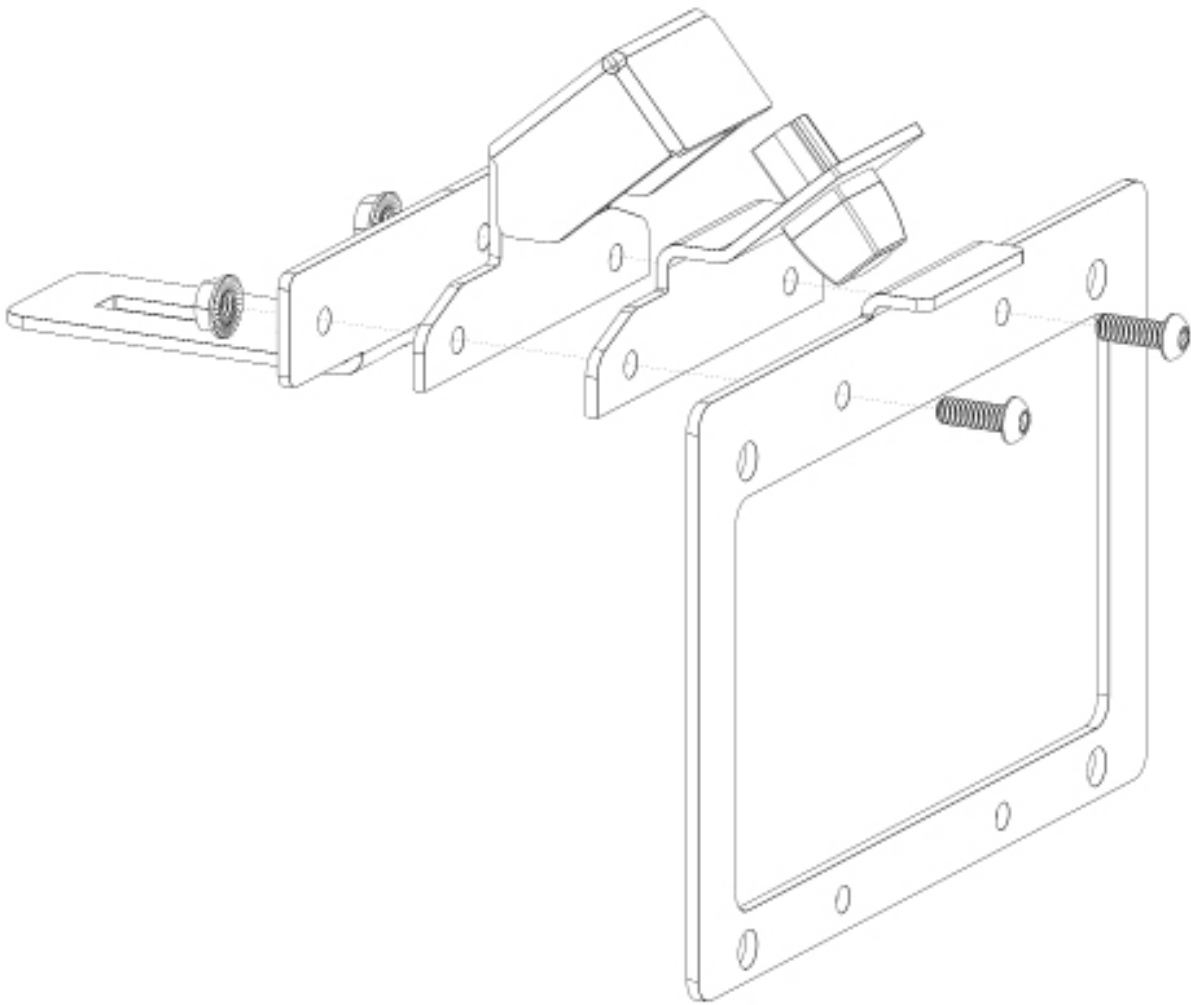

ASSEMBLY

- 2 Place the whole assembly onto the carrier-side bracket that is installed behind your spare and bolt them together using the 3/8"-16 X 3/4" carriage bolt and 3/8"-16 wing nut. It is up to you whether you want to put the carriage bolt through the top or bottom. When placing the assembly onto the bracket, make sure the small rectangular tab of the bracket is sticking up through the slot.

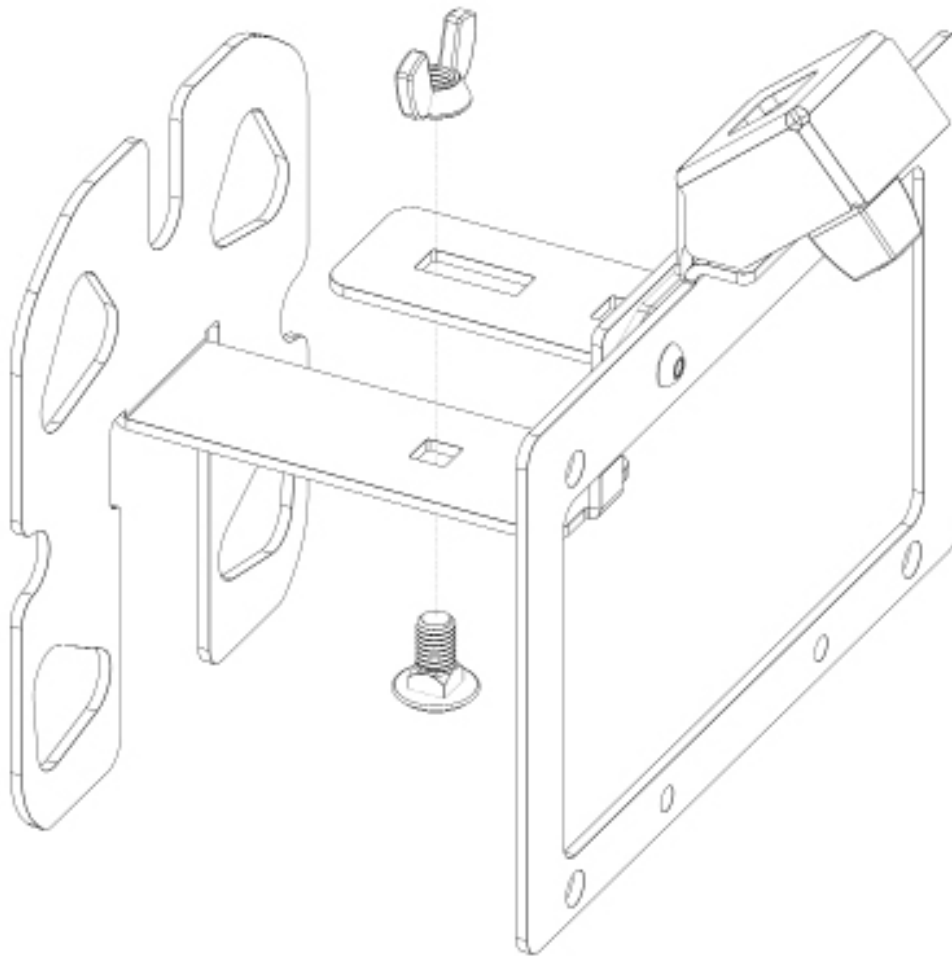

ASSEMBLY

- 3 With everything assembled, take the film off of the small white LED light and stick it to the bottom of the tab on the top of the license plate bracket in the area shown below. It can go anywhere on the tab but it works best if you place it as far out as possible.

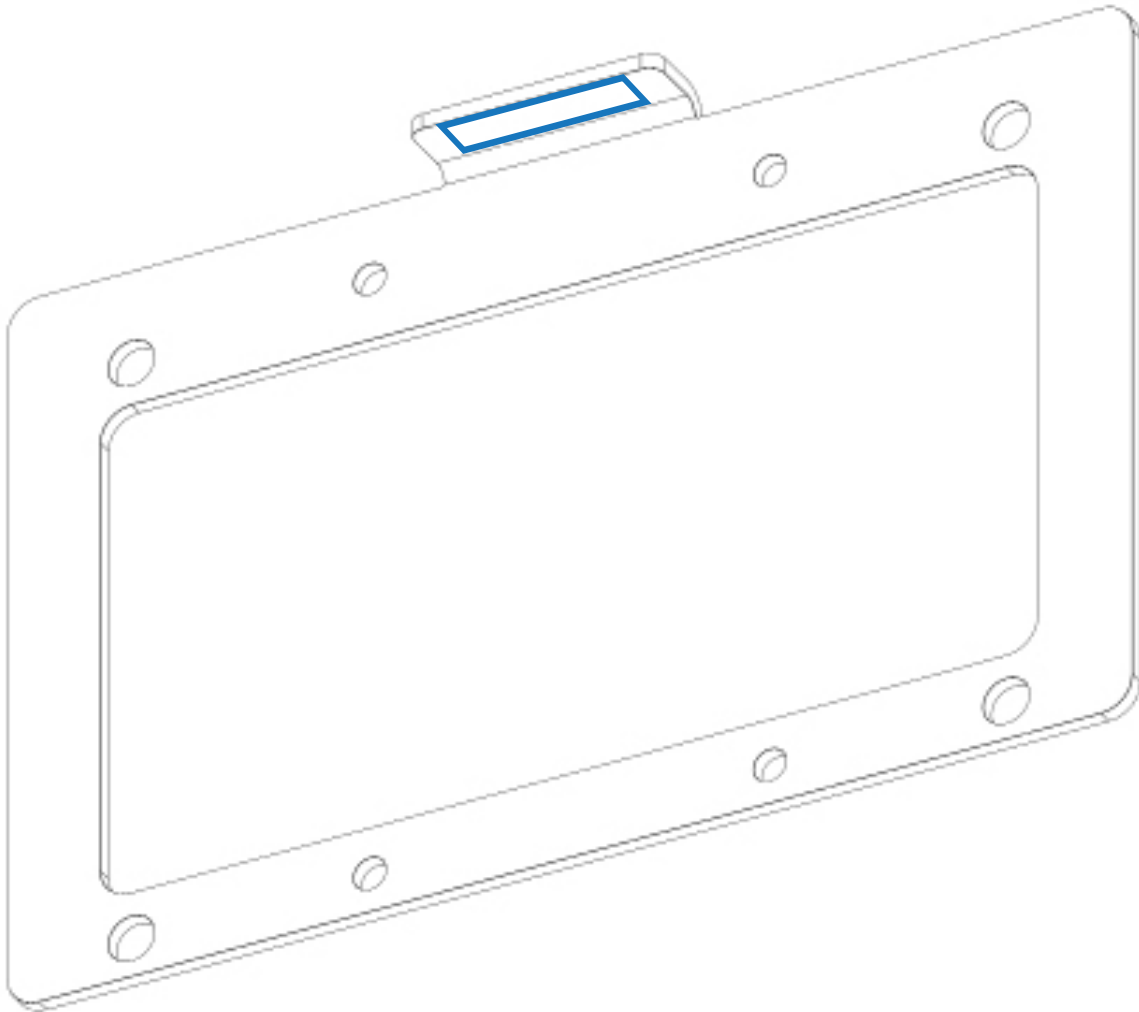

- 4 Once everything is in place, all there is left to do is attach your license plate using the 1/4"-20 X 3/4" button head bolts and 1/4"-20 serr. flange nuts.

4Runner 360 Camera Relocation Wiring

Between body and hatch

Five wires in a black sheath – (shown as a gray sheath in the install video.)

White – Connect to the white wire at the camera connector.

Green – Connect to the brown wire at the camera connector.

Black – Connect to the black wire at the camera connector.

Red – Connect to the red wire at the camera connector.

Bare – No connection

Twisted red and white wires – connect to twisted blue and white wires at the camera connector. Red to blue, white to white. We recommend slightly twisting the wires running to the carrier as well to help with any interference.

The green wire for license plate wiring is the same size as another green wire in the harness. (It is mentioned as larger in the video.) We recommend metering it to verify it has 12v when the vehicle lights are on and 0v when the vehicle lights are off.

The large white ground wire has a black stripe.

Wires at the camera connector - Twisted blue and white wires, black, brown, white, red.

