

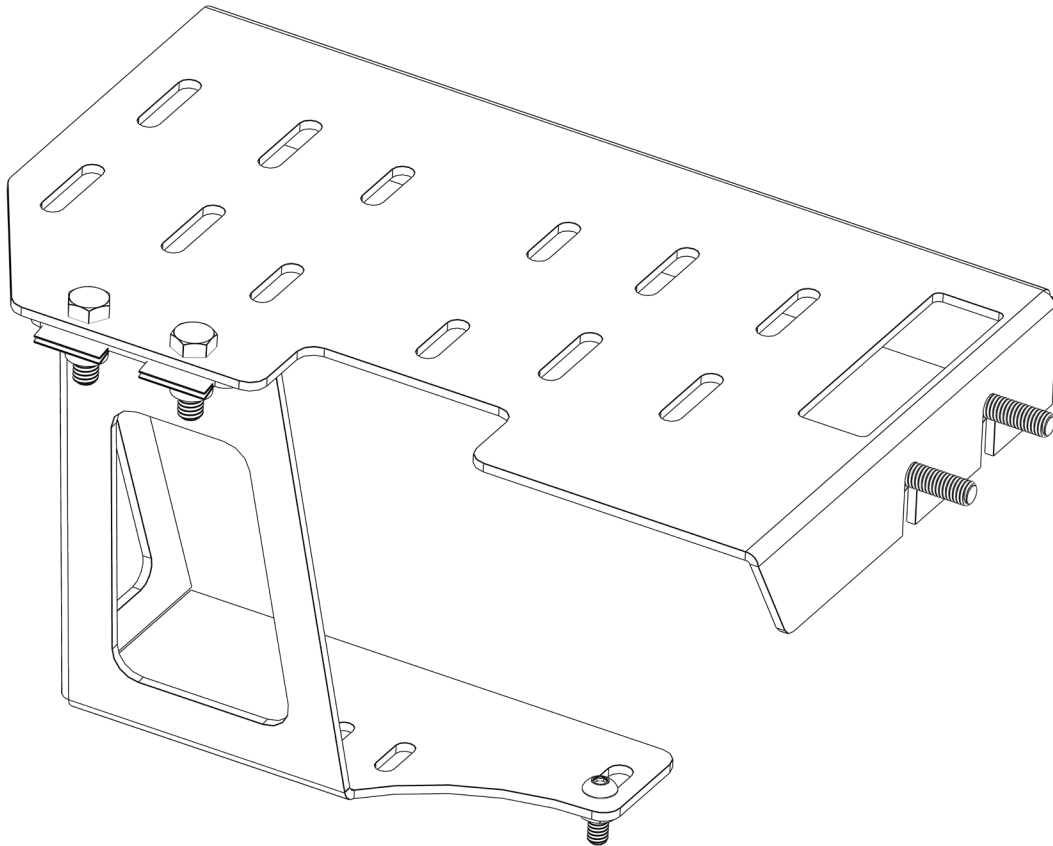

VICTORY 4X4

# 5TH GEN 4RUNNER & GX460 AIR COMPRESSOR MOUNT

## INSTALL INSTRUCTIONS



**Please read the mounting instructions below carefully before attempting to install.**

**Be sure to check out the install video on the product page, if available.**

Thank you for purchasing from Victory 4x4! Checkout our website, [victory4x4.com](http://victory4x4.com) for other great off-road products. Be sure to rate and review our product online. If you have any questions or are missing parts, please don't hesitate to call us at 269-459-8447!

# INCLUDED HARDWARE

2x

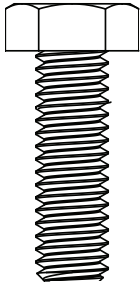

5/16"-18 Stainless  
Hex Head

1x

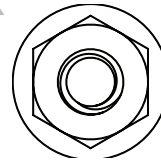

M6 Serrated  
Flange Nut

2x

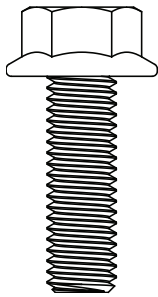

M8x1.25mm Thread  
Hex Head

1x

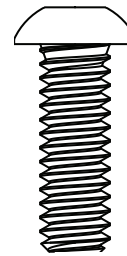

M6 Button Head

2x

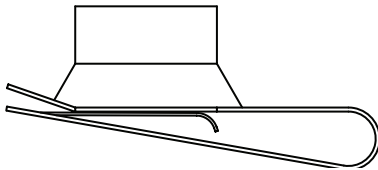

3/8"-16 Clip on  
Barrel Nut

2x

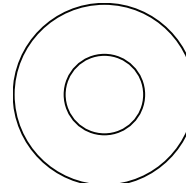

3/8" USS  
Flat Washer

# INCLUDED PARTS

1x

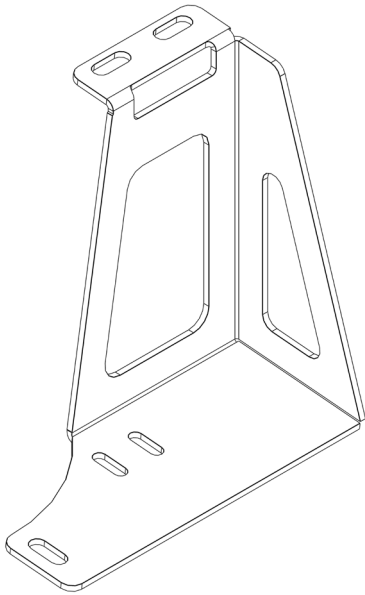

1x

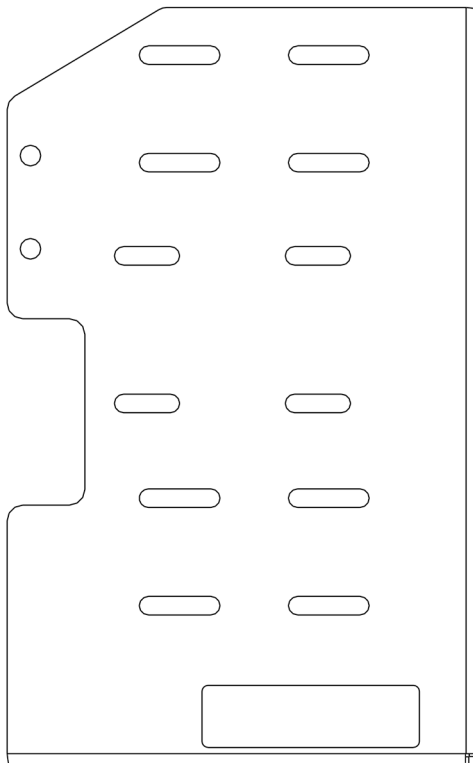

# INSTALLATION

- 1a.** With your hood open, start by removing the factory harness in the driver side corner, as shown below, with a 10mm socket. If you're installing on a GX460, there may be a plastic cover piece secured by (4) plastic clips you have to remove first before you can access the harness. With the plastic cover out of the way, there will be a bracket on the side of the fuse box that one of the clips secured into, you can then just remove it by pinching the (2) tabs.



# INSTALLATION

- 1b.** Some newer models have an additional fuse box that you need to remove to manipulate slightly to get our bracket to fit over it. If your vehicle has the extra fuse box, as shown below, you need to remove it and cut the flange off as marked with a sharpie below. Once the corner is cut, re-install back on loosely for now using the factory threaded holes.



# INSTALLATION

2. Once the factory harness is removed, place the provided smaller bracket in its place in the orientation shown below, with the factory harness back on top. With everything now lined up, thread back in the bolt just removed to secure the harness to the bracket. Then take the provided M6 button head and flange nut and secure them in the slot on the end of the bracket, also shown below. There should be plenty of room to reach up into the wheel well with the nut to access the M6 bolt, once started you can then tighten with a 4mm hex.



3. Next, take the (2) provided clip nuts and attach them to the bracket as shown in the orientation below.

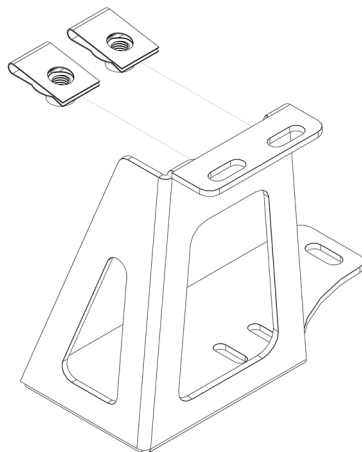



# INSTALLATION

4. Take the (2) provided M8 hex head bolts and thread them into the factory threaded holes just above the fender, leaving about 1/4" out. At this time secure your compressor to the larger provided bracket before installing any further. After your compressor is secure to the bracket, slide it over the M8 bolts in the orientation shown below.

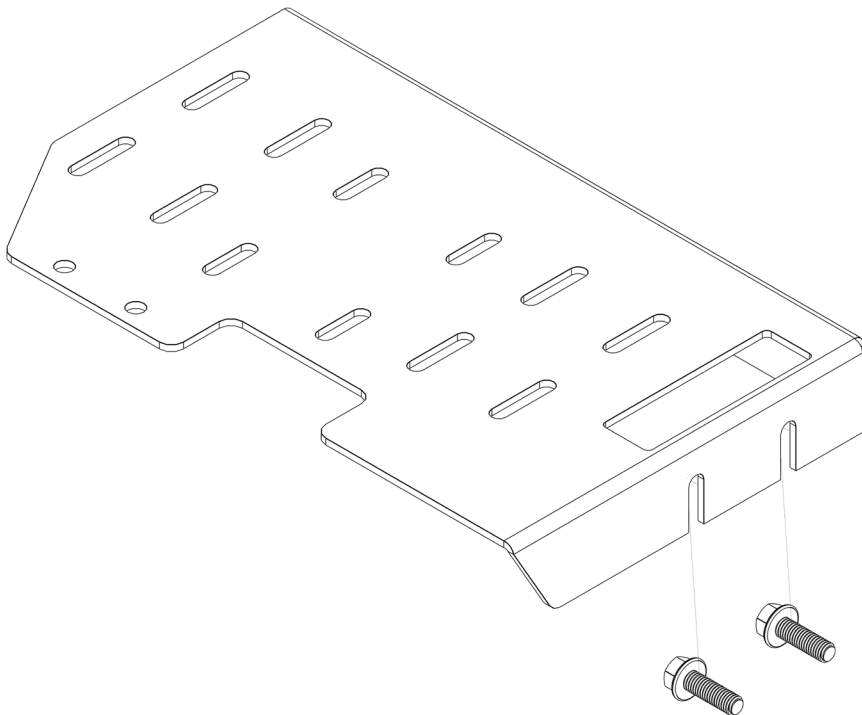

# INSTALLATION

5. Once the bracket is slid over the M8 bolts, take (2) of the provided 5/16" hex head bolts and 3/8" washers and thread them into the clip nuts, as shown below. You may need to make some minor adjustments to the clips nuts to get the holes to line up on the bracket to thread the bolts through.

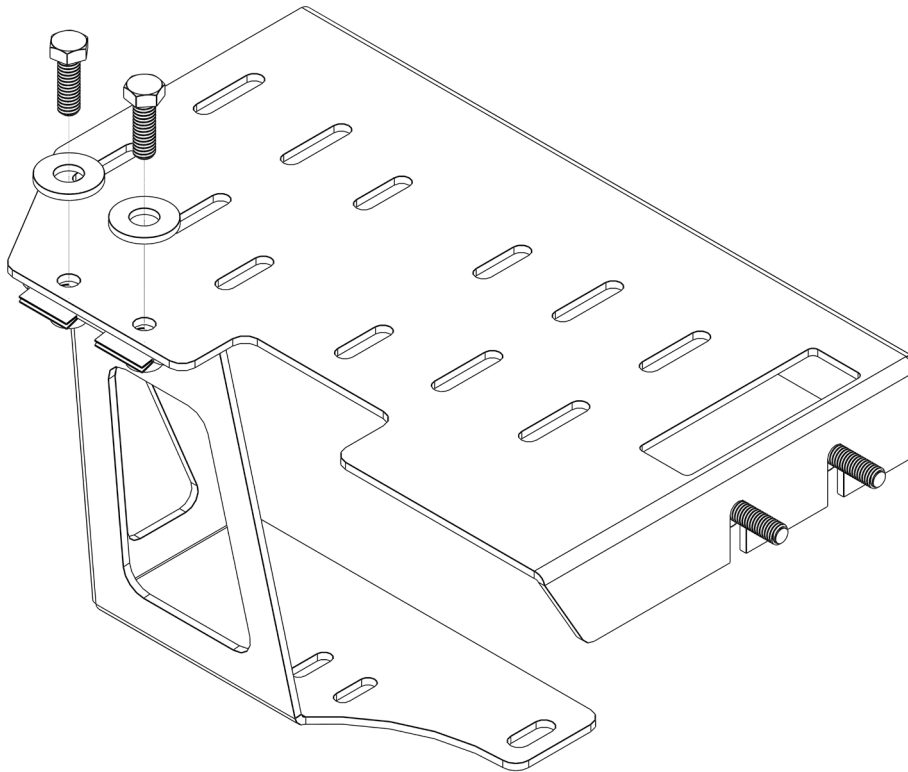

6. With the 5/16" bolts tight in the clip nuts, take a 13mm ratchet wrench and tighten the M8 bolts in the side of the fender through the top window on the bracket as shown below.



# INSTALLATION



7. Before completing your install, ensure that all of your hardware is tight and if you have any tubes or hoses touching the bracket you may need to use the provided zip ties to adjust the hoses or tubes out of the way to prevent rubbing.

