



TABLE OF CONTENTS

5TH GEN 4RUNNER REAR WINDOW MOLLE PANEL.....	2
4TH GEN 4RUNNER REAR WINDOW MOLLE PANEL.....	8
3RD GEN 4RUNNER REAR WINDOW MOLLE PANEL.....	14



VICTORY 4X4

5TH GEN 4RUNNER REAR WINDOW MOLLE PANEL

INSTALL INSTRUCTIONS

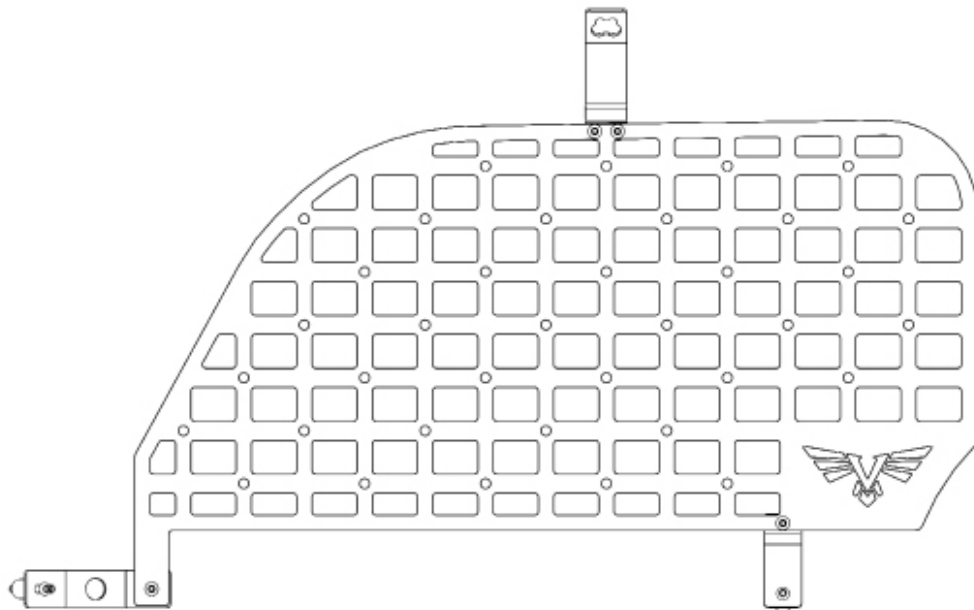

Please read the mounting instructions below carefully before attempting to install.

Be sure to check out the install video on the product page, if available.

Thank you for purchasing from Victory 4x4! Checkout our website, victory4x4.com for other great off-road products. Be sure to rate and review our product online. If you have any questions or are missing parts, please don't hesitate to call us at 269-459-8447!

INCLUDED HARDWARE

2x

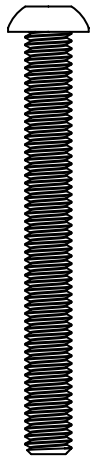

55 mm M6
Button Head

4x

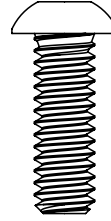

1/4"-20 X 3/4"
Button Head

2x

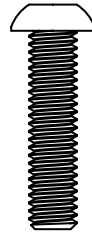

25 mm M6
Button Head

4x

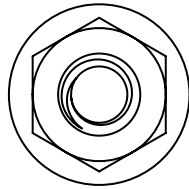

1/4"-20
Serr. Flange Nut

2x

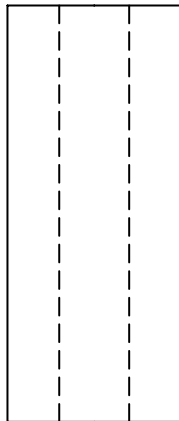

5/8" OD X 1-1/2" long
Unthreaded Nylon Spacer

INCLUDED PARTS

1x

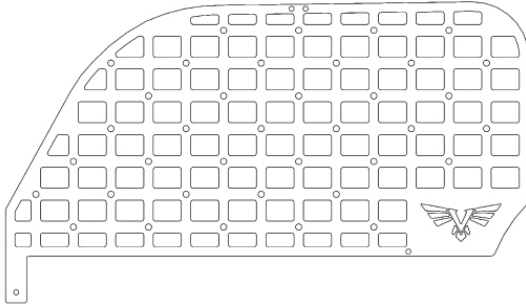

1x

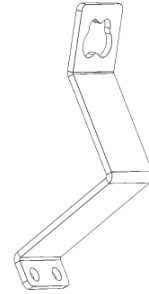

Top

1x

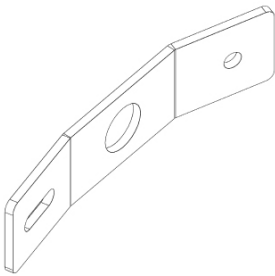

Rear

1x

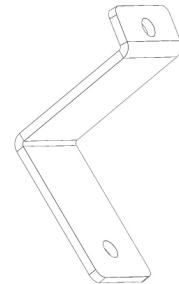

Front

INSTALLATION

- 1** Start by loosely installing the bottom mounts using the 55mm M6 button head and the 5/8" OD spacer. When installing the rear mount, you can use the center hole as a place to re-mount the factory cargo net hook.

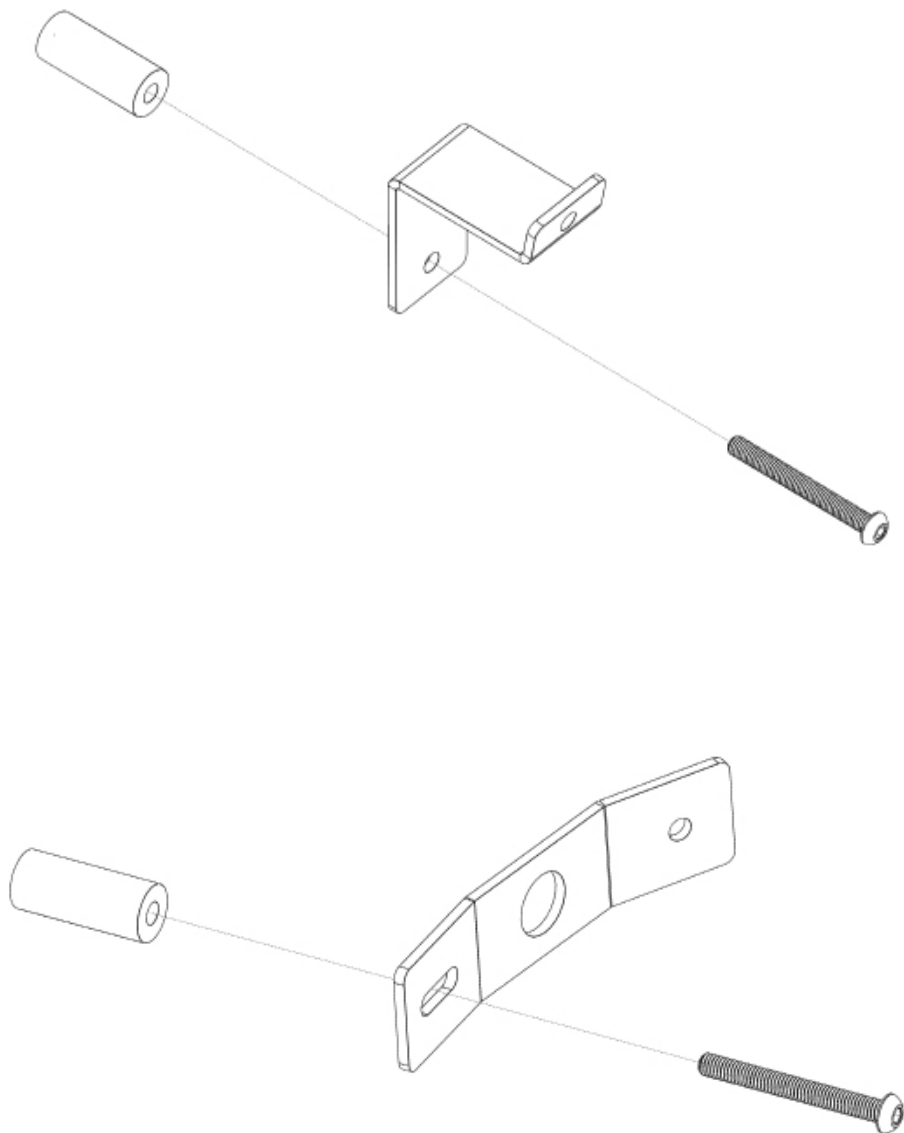

INSTALLATION

- 2** Next, put the factory hanger through the top mount and use the stock hardware to loosely mount it to the vehicle.

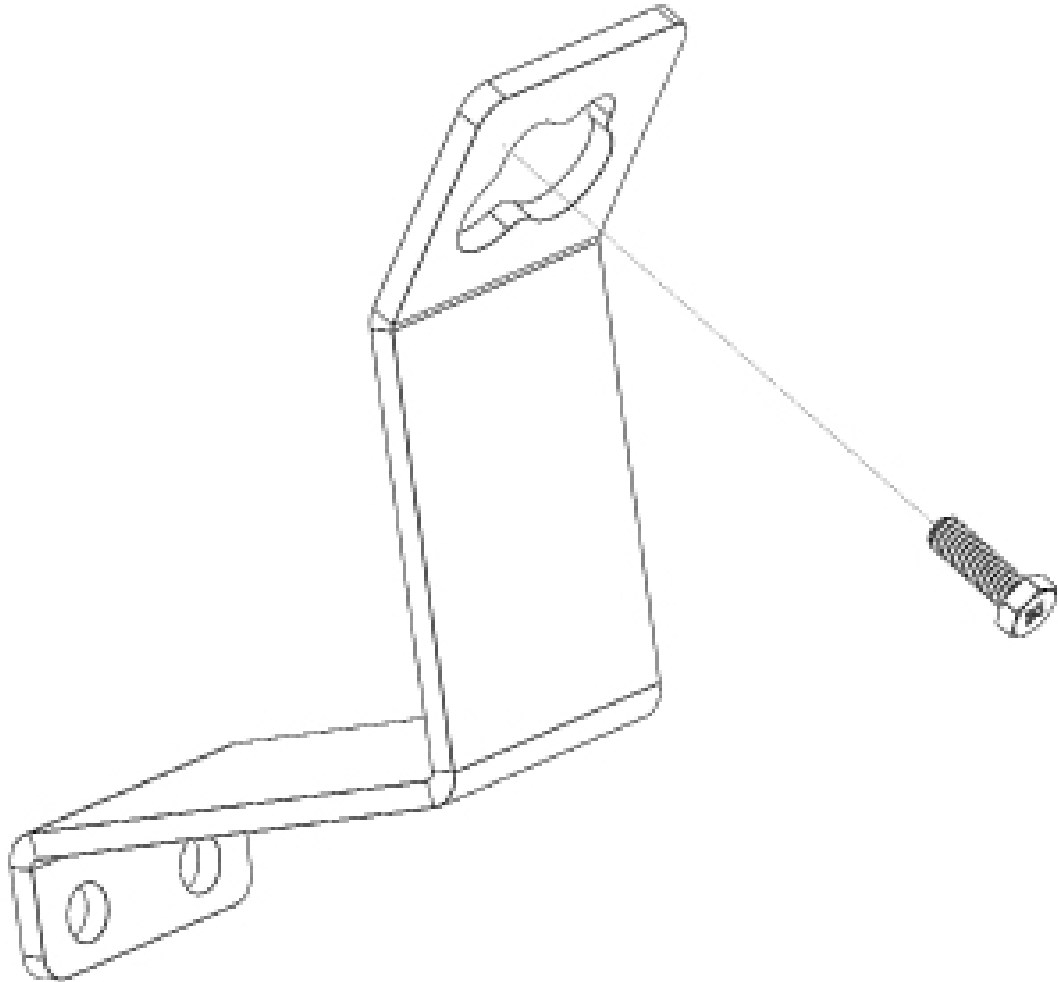

INSTALLATION

- 3** With all 3 mounts loosely installed, mount the panel to them, starting with the top mount. Once the panel is attached to all 3 mounts, adjust the positioning in the window and tighten it into place once it is in the desired position.

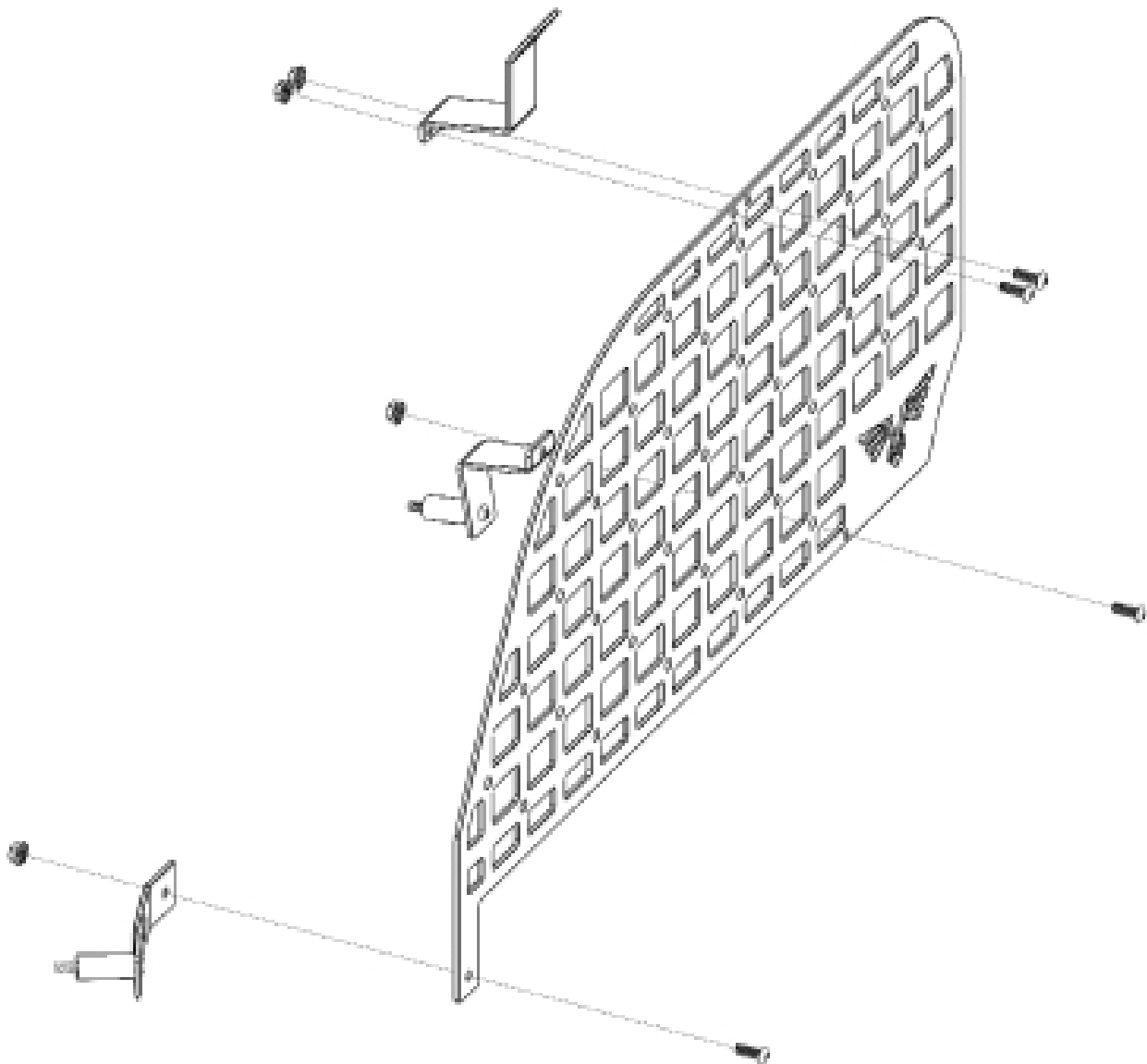



VICTORY 4X4

4TH GEN 4RUNNER REAR WINDOW MOLLE PANEL

INSTALL INSTRUCTIONS

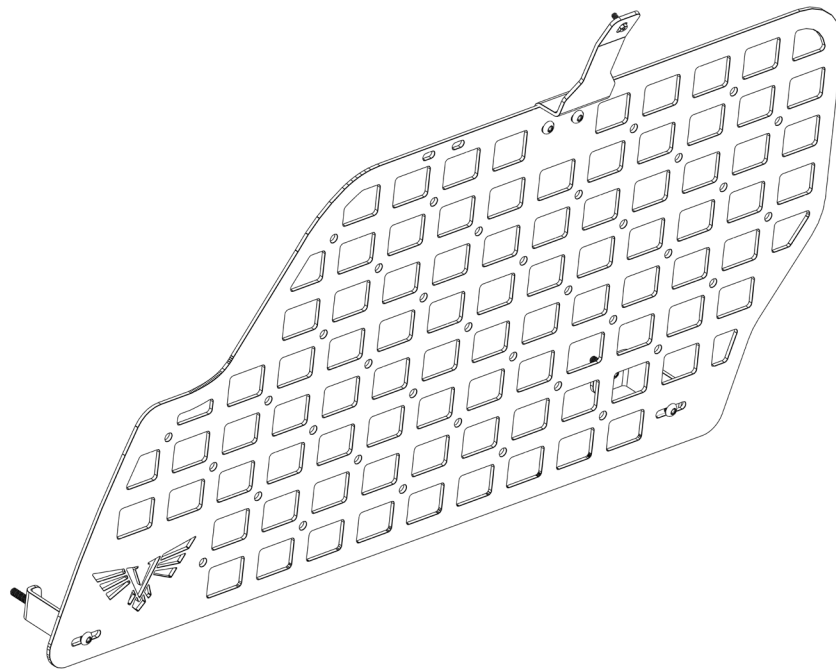

Please read the mounting instructions below carefully before attempting to install.

Be sure to check out the install video on the product page, if available.

Thank you for purchasing from Victory 4x4! Checkout our website, victory4x4.com for other great off-road products. Be sure to rate and review our product online. If you have any questions or are missing parts, please don't hesitate to call us at 269-459-8447!

INCLUDED HARDWARE

2x

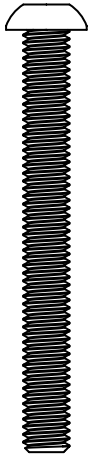

55 mm M6
Button Head

4x

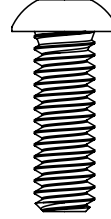

1/4"-20 X 3/4"
Button Head

2x

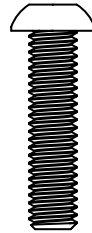

25 mm M6
Button Head

4x

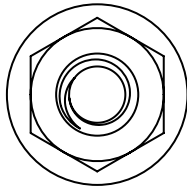

1/4"-20
Serr. Flange Nut

2x

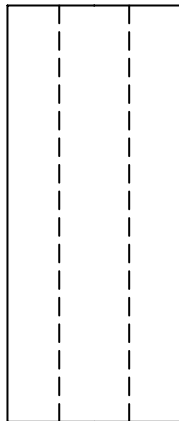

5/8" OD X 1-1/2" long
Unthreaded Nylon Spacer

INCLUDED PARTS

1x

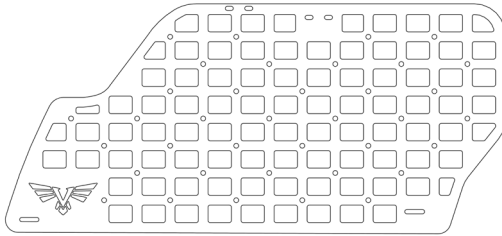

1x

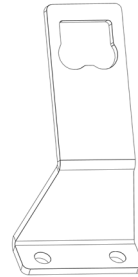

Top (2003-2005)

1x

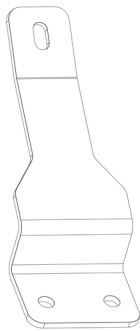

Top (2006-2009)

1x

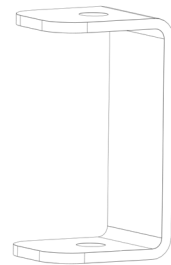

Front

1x



Rear

INSTALLATION

- 1 Start by mounting the top mount to the vehicle. You do this by setting the factory hangers over the top of the mount and then loosely attaching it to the vehicle using the factory hardware. The top mount you need to use will depend on the model year of your vehicle. See "included parts" section to see which one you need.

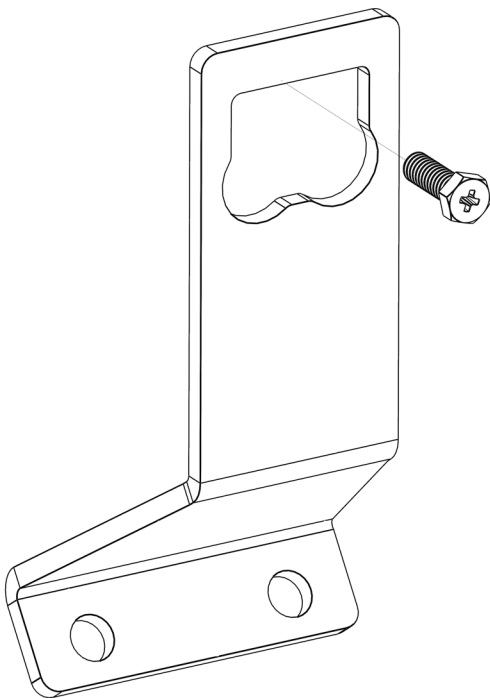

2003-2005

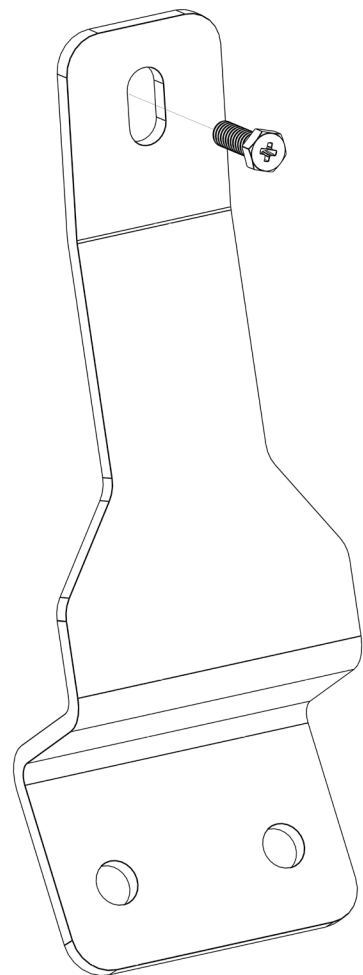

2006-2009

INSTALLATION

- 2** Next, loosely install the bottom mounts using the 55mm M6 button head bolts. Make sure that the open end of the rear mount is open towards the front of the vehicle, and the open end of the front mount is open towards the rear of the vehicle.

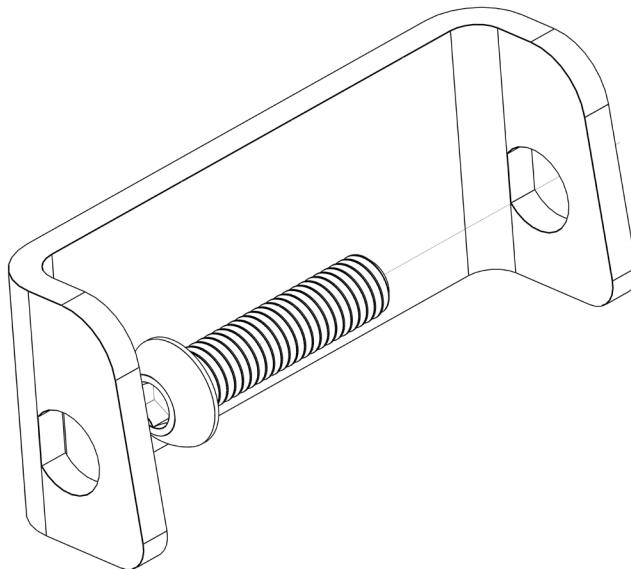
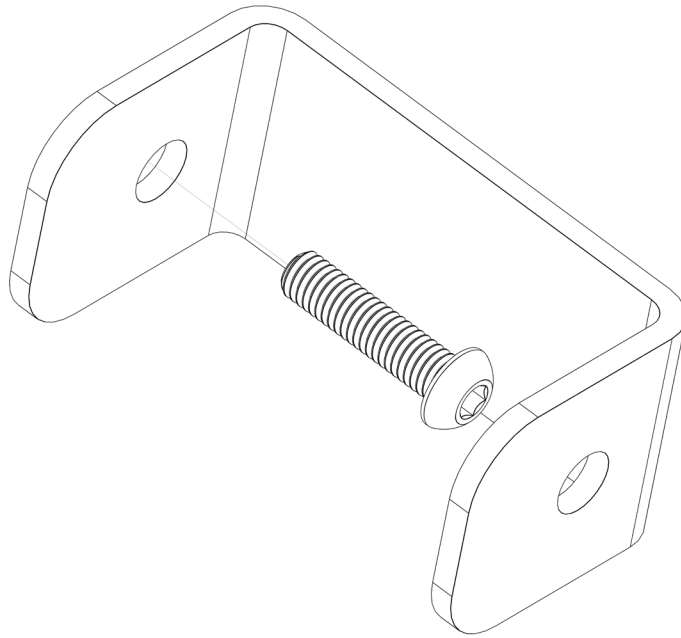

INSTALLATION

- 3** With all 3 mounts loosely installed, mount the panel to them, starting with the top mount. Once the panel is attached to all 3 mounts, adjust the positioning in the window and tighten it into place once it is in the desired position.

2003-2005

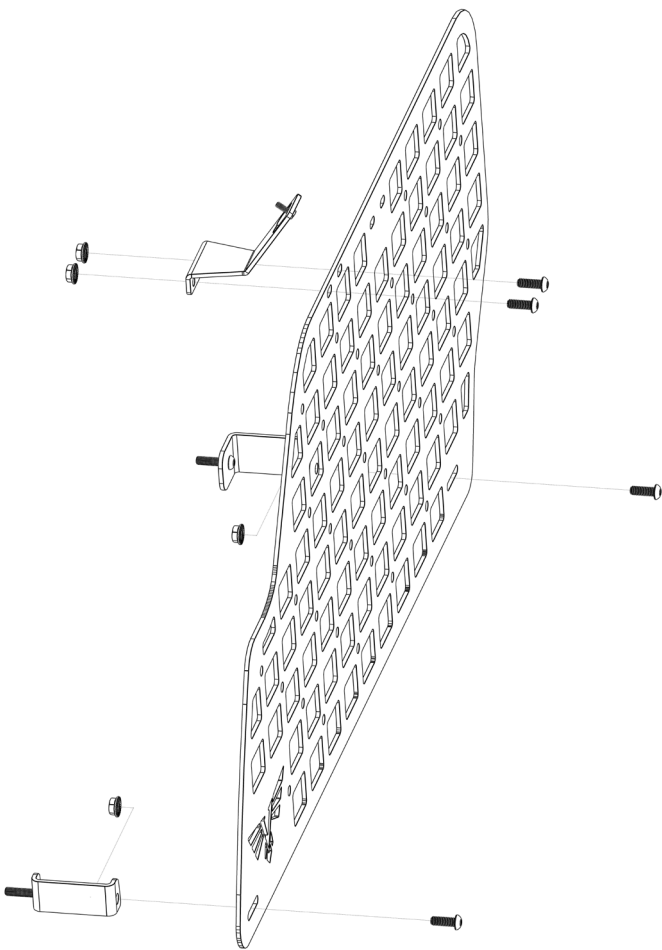

2006-2009

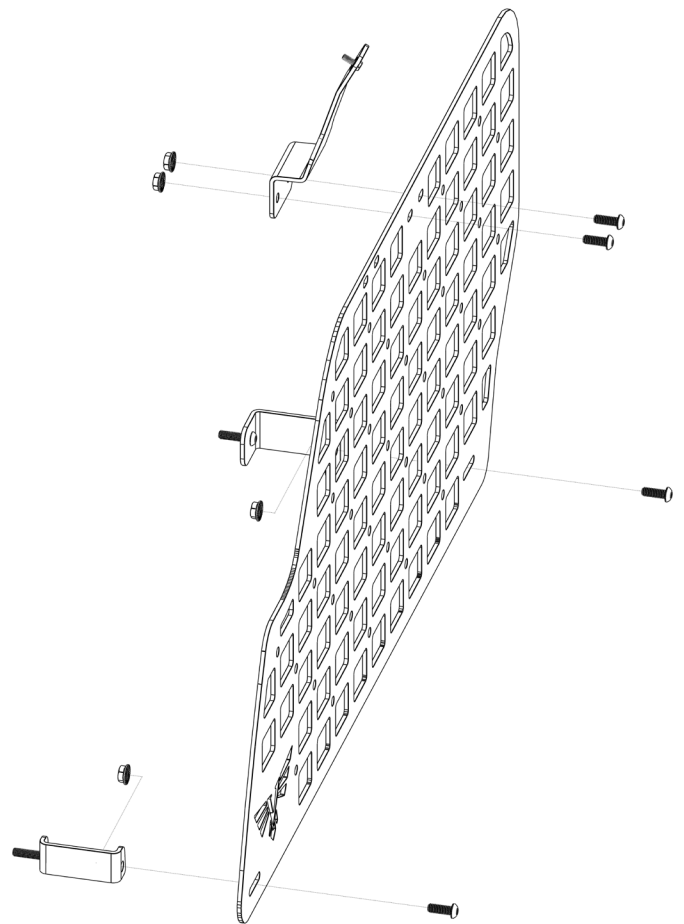



VICTORY 4X4

3RD GEN 4RUNNER REAR WINDOW MOLLE PANEL

INSTALL INSTRUCTIONS

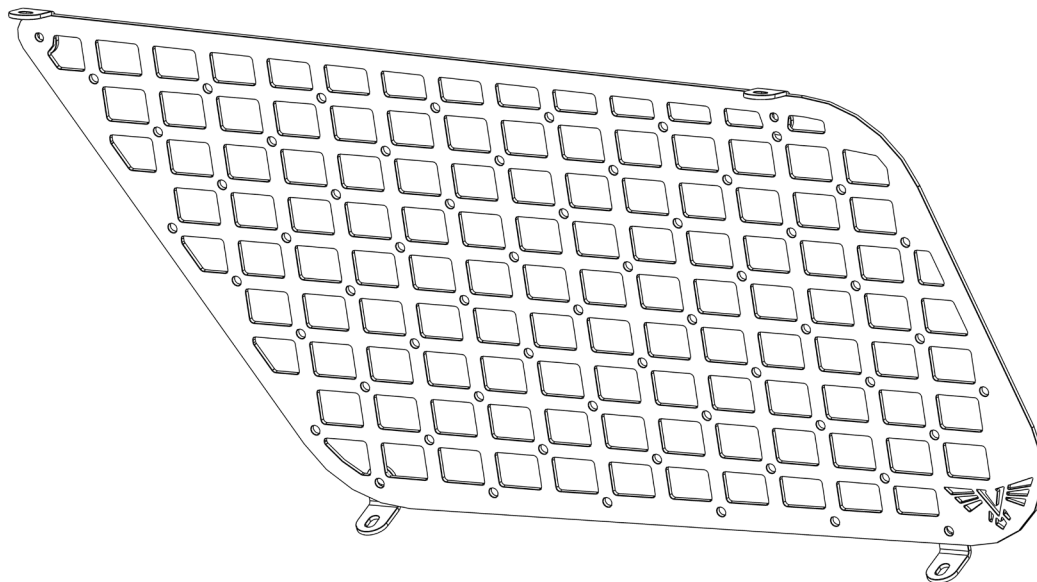

Please read the mounting instructions below carefully before attempting to install.

Be sure to check out the install video on the product page, if available.

Thank you for purchasing from Victory 4x4! Checkout our website, victory4x4.com for other great off-road products. Be sure to rate and review our product online. If you have any questions or are missing parts, please don't hesitate to call us at 269-459-8447!

INCLUDED HARDWARE

4x

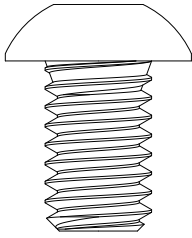

5/16-18 x 1/2"
Button Head

4x

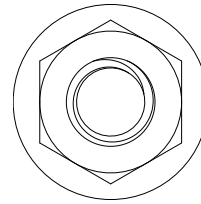

5/16-18
Flange Nut

4x

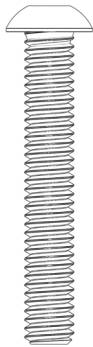

5/16-18 x 2"
SS Button Head

4x

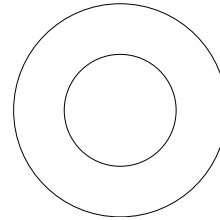

8.4mm x 16mm
Washer

2x

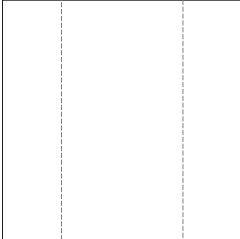

3/4"OD x 3/4"
Spacer

2x

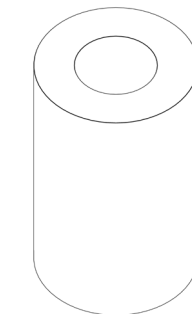

3/4"OD x 1-1/4"
Spacer

6x

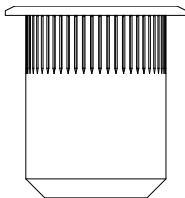

5/16-18
Rivet Nut

1x

Riv-Nut Tool
Bolt Pack

INCLUDED PARTS

1x

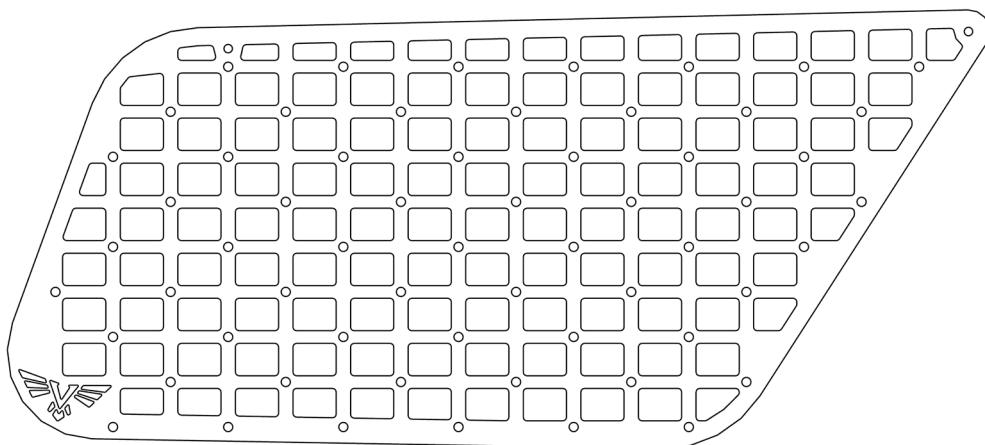

4x

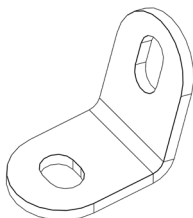

INSTALLATION

1. Start by mounting the (4) provided brackets to the panel in the orientation shown below, using the provided 1/2" button heads and flange nuts. Leave these brackets somewhat loose to be able to adjust if needed.

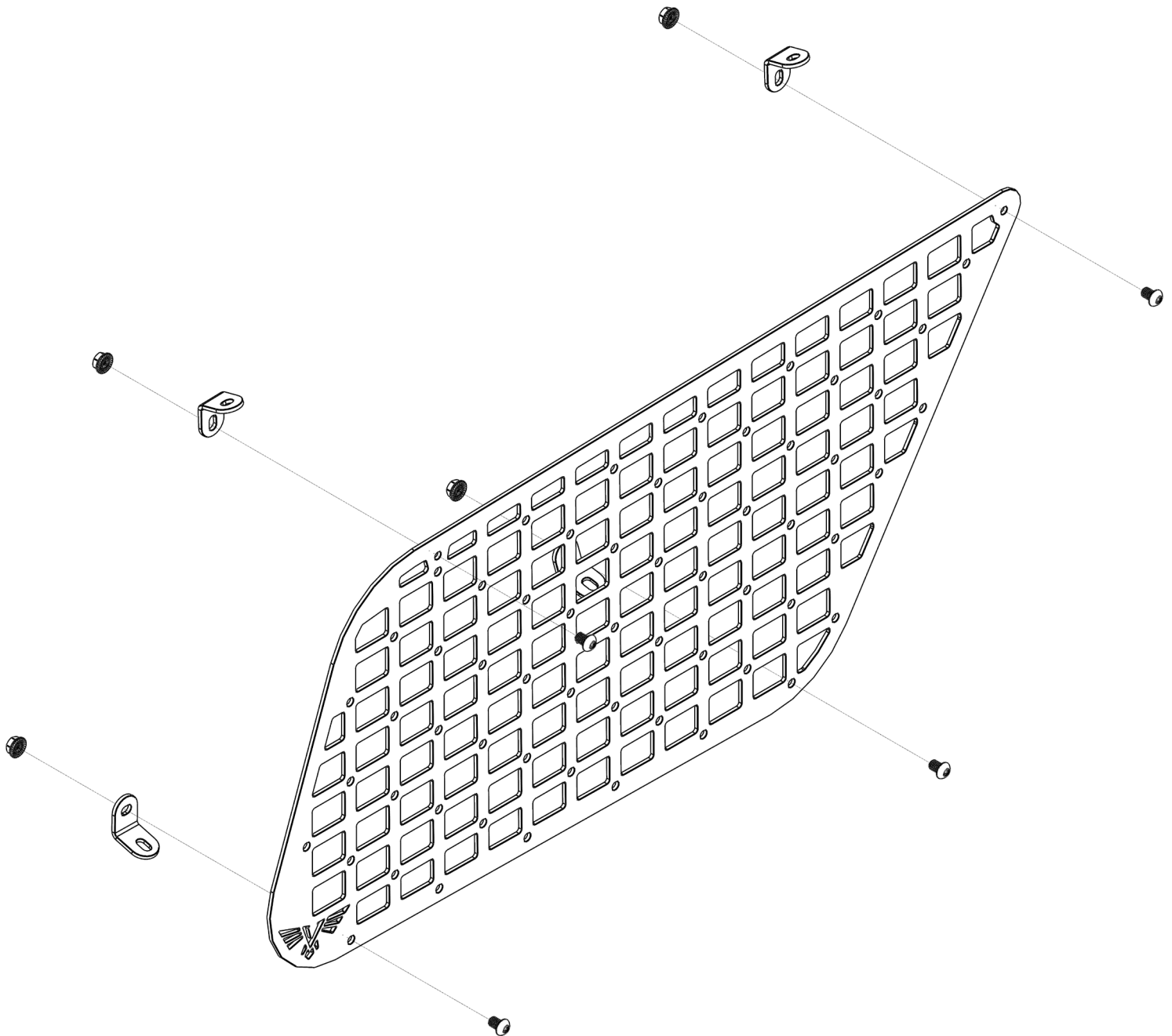

INSTALLATION

- 2.** Once the brackets are installed on the panel, hold it up in the window and adjust the brackets if needed so that they are flush and lay flat with the plastic. Once the brackets are flat and adjusted properly, tighten them down all the way.

- 3.** Next, install some masking tape on your plastic where each bracket lined up to give you something to mark on in case you make a mistake and need to wipe a mark away. Once the tape is installed, hold the panel back up with the brackets and center line mark the hole locations where the brackets line up.



INSTALLATION

- 4.** Now that you have the center line marked, measure 1-3/4" out from the window and mark a horizontal line over the center line mark to make a cross shape, which will be the center point to drill. Once all (4) holes are marked, use a 5/32" drill bit to drill out a pilot hole through the plastic in each location. Once you have your holes in the plastic, keep pushing a little harder until you hit the metal, and apply a little pressure to leave a mark so that you know where to drill in the metal once that plastic panel is removed. Be sure when drilling to try and stay as square to the surface you are drilling as possible.

- 5.** You can now remove the masking tape, and start to disassemble the rear cargo area and remove the plastic in which you just drilled into. For further instruction or help on how to remove the plastic, watch our install video on the product page on our website.

INSTALLATION

6. With the plastic removed, you now have access to the metal in which you marked earlier to drill. Take that same 5/32" drill bit as before and bore all (4) holes all the way through. Once those holes are drilled out, take the provided 17/32" drill bit and drill those holes out to size.



INSTALLATION

7. With all (4) holes drilled to size, take the provided riv-nuts and riv-nut tool and secure the riv-nuts into the drilled out holes in the metal, using an 11/16" wrench to hold the center nut and a 1/2" socket ratchet to tighten the top bolt. Once the riv-nut feels close to tight, give it about an extra 1/4 turn to make sure not to over tighten. We provide (2) extra riv-nuts in case of any mess ups or accidents. Once the riv-nut is installed, back the bolt out and re-install the new nut on the tool. If you have never installed an riv-nut before or need any further explanation, please check out our install video on the product page on our website.



INSTALLATION

8. Once all (4) of your riv-nuts are installed, the last thing you need to do before you can reinstall your plastic panel is to drill out all (4) of your pilot holes in the plastic to 3/4" to accommodate for the provided spacers. We found the easiset way to do this is by using a step bit.



9. You can now start to assemble the plastic back together in the reverse order of the same way you took it apart. Don't forget to reconnect your light harness and any other small screws.

INSTALLATION

- 10.** With everything now back together, you can take the (2) provided longer aluminum spacers and pop them in the bottom holes on the plastic so they are resting on the installed riv-nuts. Then take (2) of the provided longer 2" button heads with a washer and place them through the top brackets with the shorter (2) aluminium spacers up into the plastic and then tread the button heads in place hand tight for now. Once those are in place, you can then thread in the remaining 2" button heads with washers through the bottom brackets into the riv-nuts through the spacers. Once all the bolts are started and in place, go around and tighten them all down with a 3/16" allen wrench.

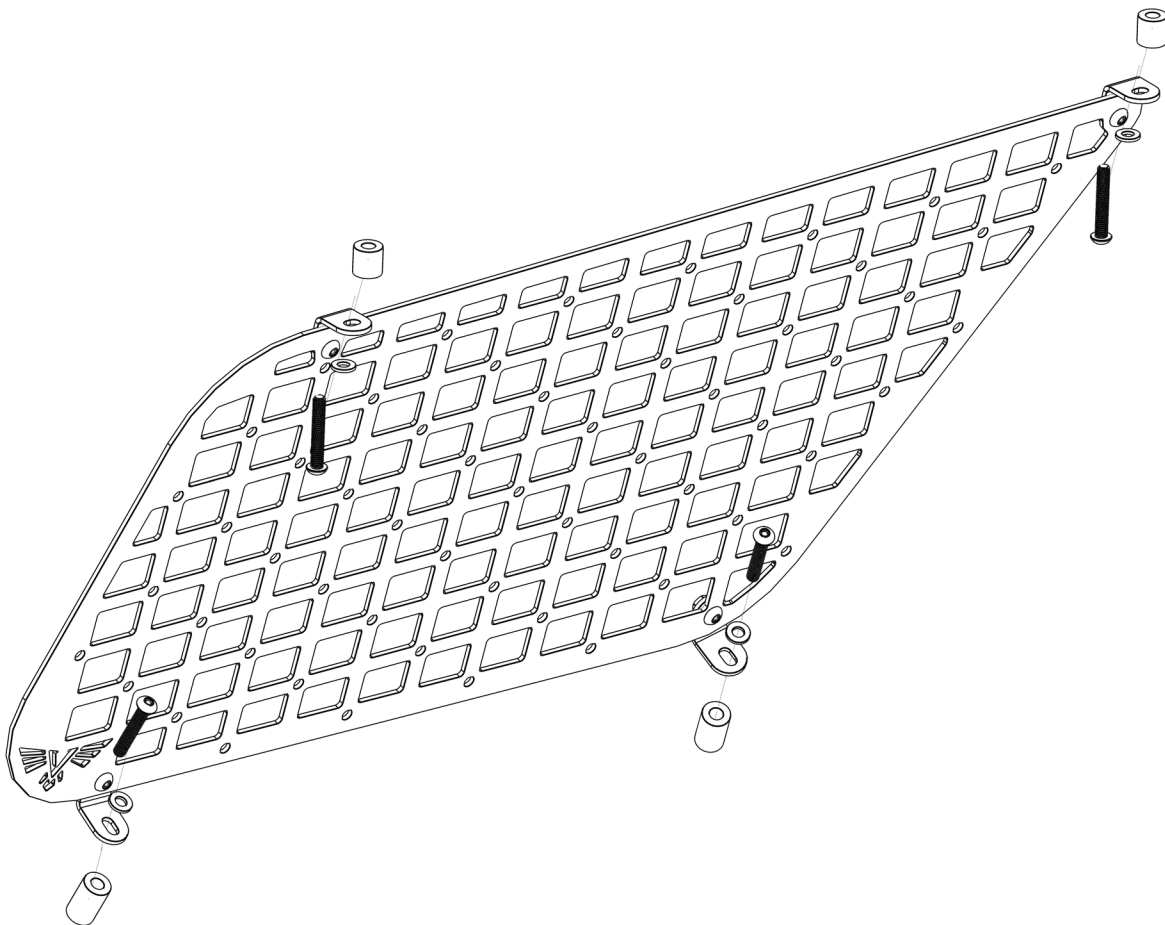

INSTALLATION

- 11.** You are now complete with your install, enjoy your new rear window molle panel. If you are installing on the passenger side, it will install the same way just repeat these same steps just make sure your panel is facing the correct direction.

