

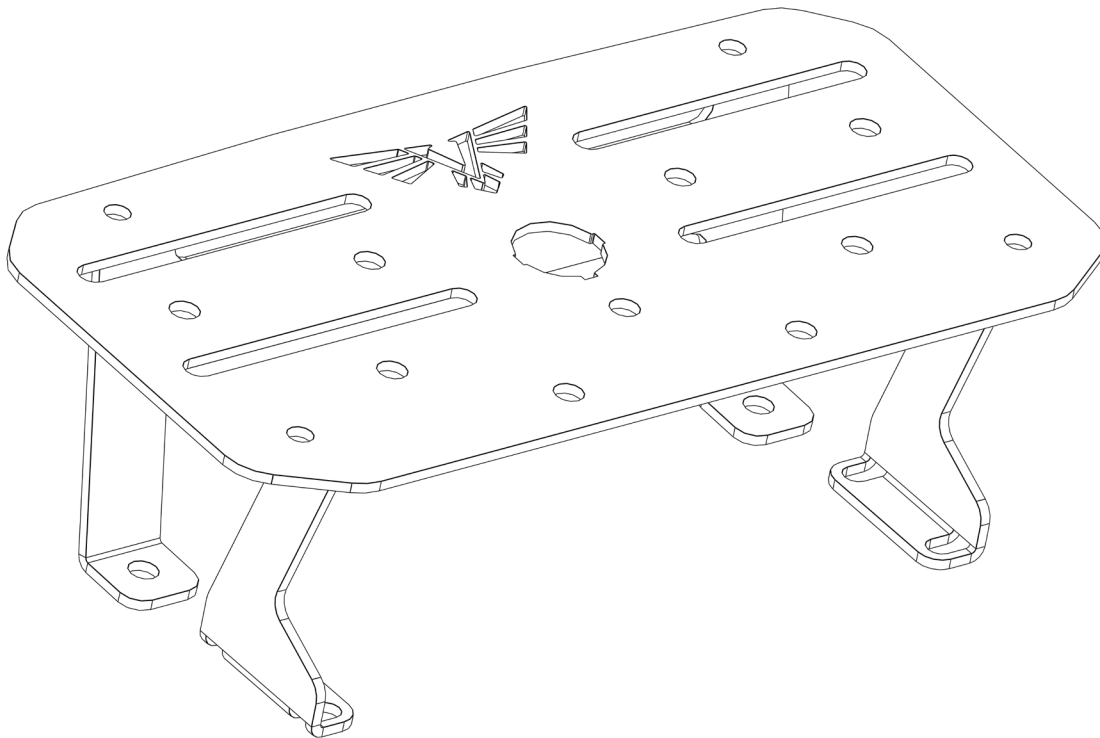

VICTORY 4X4

TOYOTA TUNDRA 2022+ DASH ACCESSORY MOUNT

INSTALL INSTRUCTIONS



Please read the mounting instructions below carefully before attempting to install.

Be sure to check out the install video on the product page, if available.

Thank you for purchasing from Victory 4x4! Checkout our website, victory4x4.com for other great off-road products. Be sure to rate and review our product online. If you have any questions or are missing parts, please don't hesitate to call us at 269-459-8447!

INCLUDED HARDWARE

5x

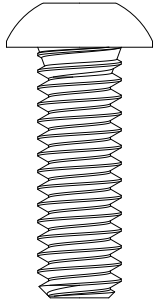

M6 Button Head

1x

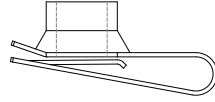

M6 Clip Nut

INCLUDED PARTS

1x

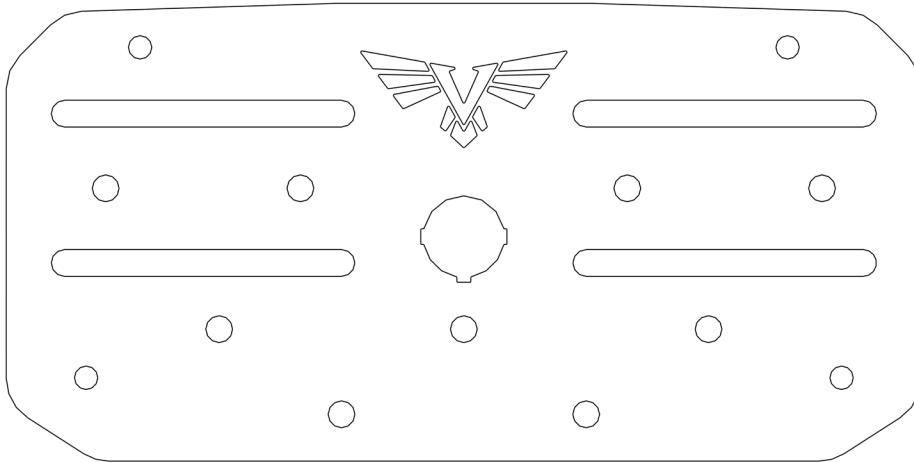

1x

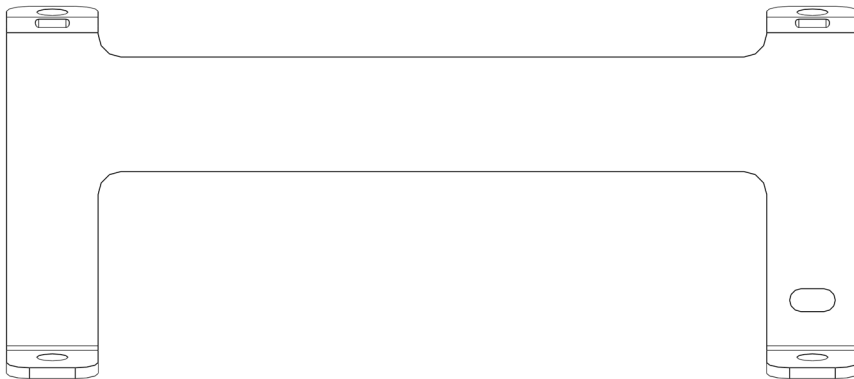

1L/1R

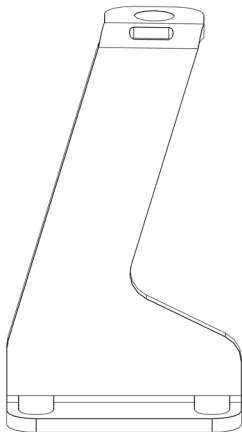

INSTALLATION

1. Start by removing the plastic cover panel behind the monitor on the dash, use a plastic pry tool or a flat head screw driver to pop the clips free to remove the plastic, as shown below.



2. Once the plastic piece is popped off, you need to disconnect the wire harness that powers the 12v plug on the back. There is a small thumb tab on the top that you will need to use a flathead screw driver to pop loose.



INSTALLATION

3. With the harness disconnected and the plastic tray free, you need to pop the 12v out from the tray. You will need to press down on the top tab with a flathead screw driver while pinching the side tabs. Once the harness pops free you pull it out from the front opening.



4. Take the 12v harness now that is removed, and pop it into the cut out on our provided face plate. Be sure to line up the (3) notches on the harness to the cut outs on the face plate.



INSTALLATION

5. With the plastic tray out of the way, you need to remove the (2) factory bolts on each side of the dash using a 10mm socket, as shown below.



6. Take the (2) smaller provided brackets and use the factory hardware that was just removed, to secure the brackets to the dash again using a 10mm socket. Make sure the bottom flanges are pointing toward each other and the center of the vehicle, as shown below (driver side).



INSTALLATION

7. Next, on the passenger side there will be an electrical connector that will need to be removed, by pinching the tabs on the bottom and pulling out. See the location below. Once removed, take the provided clip nut and slide it over the hole where the connector was clipped in.



INSTALLATION

8. Take the larger provided bracket and the provided M6 button head bolts and thread one into the clip nut on the passenger side and the other into factory threaded hole on the driver side to secure the bracket, in the orientation shown below. Tighten both down with a 4mm hex. There will also be a cut out on the inside of the bracket to clip the wire harness in that was removed, also shown below.



INSTALLATION

- 9.** With all (3) of your brackets now secure to the dash, you can take the provided face plate with the factory 12v plug in it and plug the power connector back into it, as shown below. Then take (4) provided 1/4"-20 button heads and use them to secure the face plate to the brackets, in the orientation below, and tighten them down with a 5/32" hex to complete your install.

