

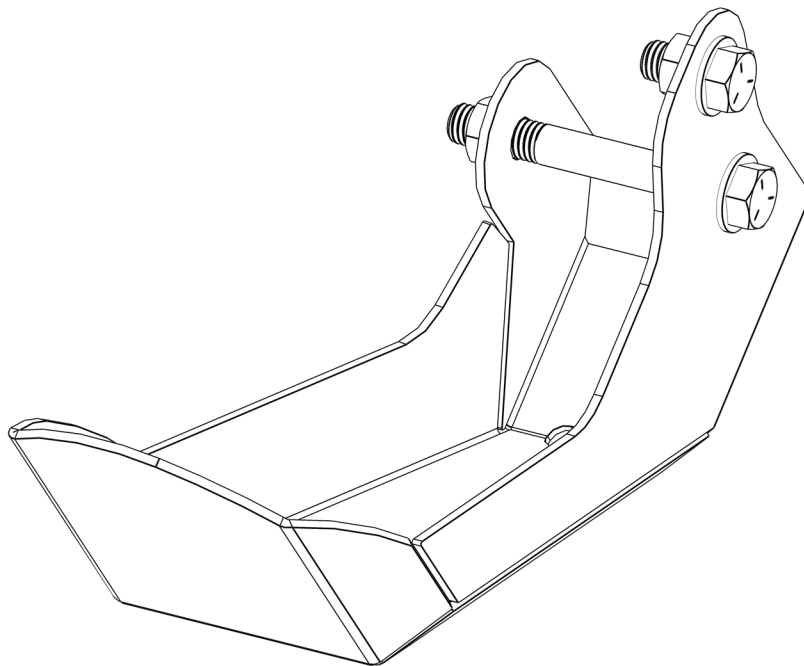

VICTORY 4X4

TOYOTA TUNDRA 2022+ REAR SHOCK SKIDS

INSTALL INSTRUCTIONS



Please read the mounting instructions below carefully before attempting to install.

Be sure to check out the install video on the product page, if available.

Thank you for purchasing from Victory 4x4! Checkout our website, victory4x4.com for other great off-road products. Be sure to rate and review our product online. If you have any questions or are missing parts, please don't hesitate to call us at 269-459-8447!

INCLUDED HARDWARE

2x

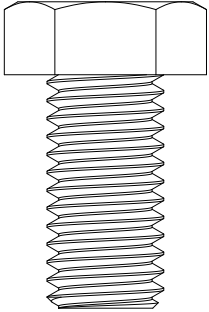

1/2"-13 1" Long
Hex Head Screw

2x



1/2"-13, 4" Long
Partially Threaded
Hex Head Screw

4x

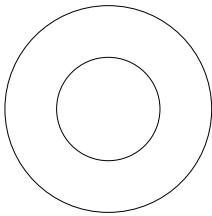

7/16" USS
Flat Washer

4x

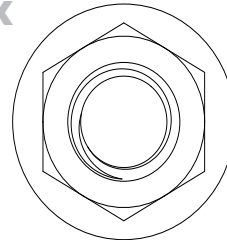

1/2"-13
Flange Nut

INCLUDED PARTS

2x

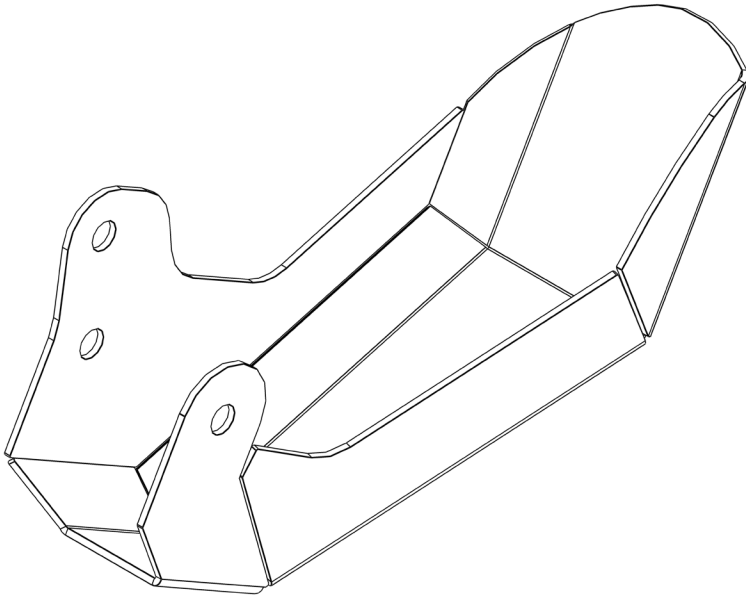

INSTALLATION

- 1.** Start by getting your vehicle up in the air, with either a jack or a hoist. Once in the air, we recommend taking the rear wheels off to make it easier for the install for easier access to the bolts.
- 2.** Once the wheels are removed, take one of the provided skids and place it over the shock, making sure all (3) holes line up with the factory holes. Double check that you have the correct skid for the side of the vehicle you're working on, with the single hole side facing the inside, and the (2) holes facing out.



INSTALLATION

3. With the skid bracket now lined up with the factory holes, take the shorter provided 1" hex bolt with a washer and feed it through the upper mounting hole. Then take a provided flange nut with a magnet stick, as shown below, and feed it up through the bottom of the skid and thread the bolt into it.



4. Now that the smaller hex bolt is threaded into place, take the longer provided 4" hex head with a washer and feed it through the bottom mounting hole of the bracket out the other side and thread a flange nut onto it.



INSTALLATION

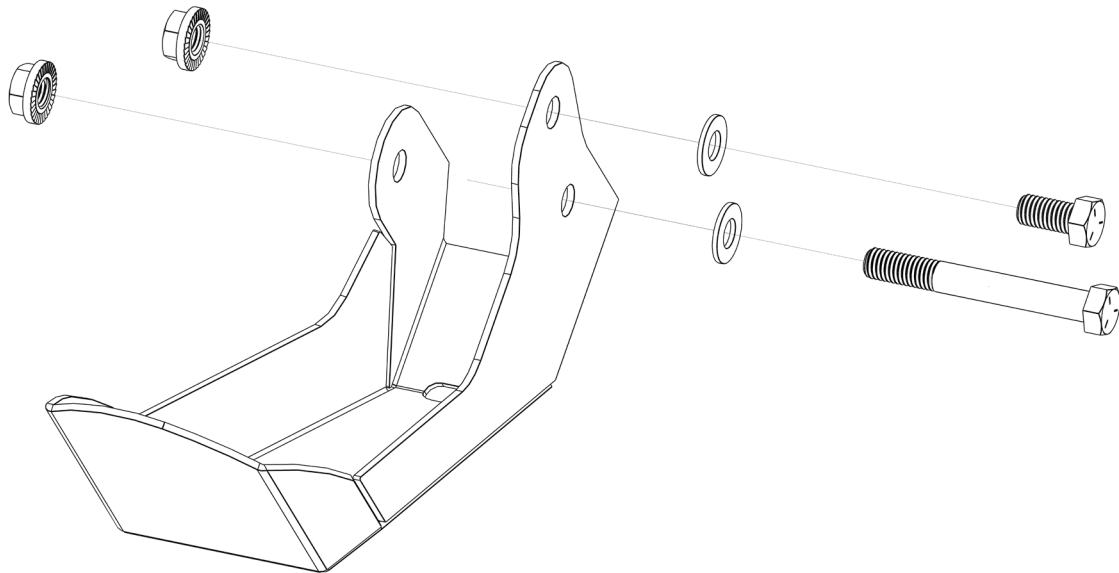

5. With all your hardware now started, there will be some movement in the bracket. Position the bracket to where both edges are parallel, as shown below, and then tighten down the bolts using a 3/4" socket and wrench, starting with the top bolt. Make sure there is adequate clearance between the shock and the skid before fully tightening down.



INSTALLATION

6. With all of your hardware now tight with adequate space inbetween the skid and shock, you will need to repeat this same process on the opposite side of the vehicle to complete your install.

