

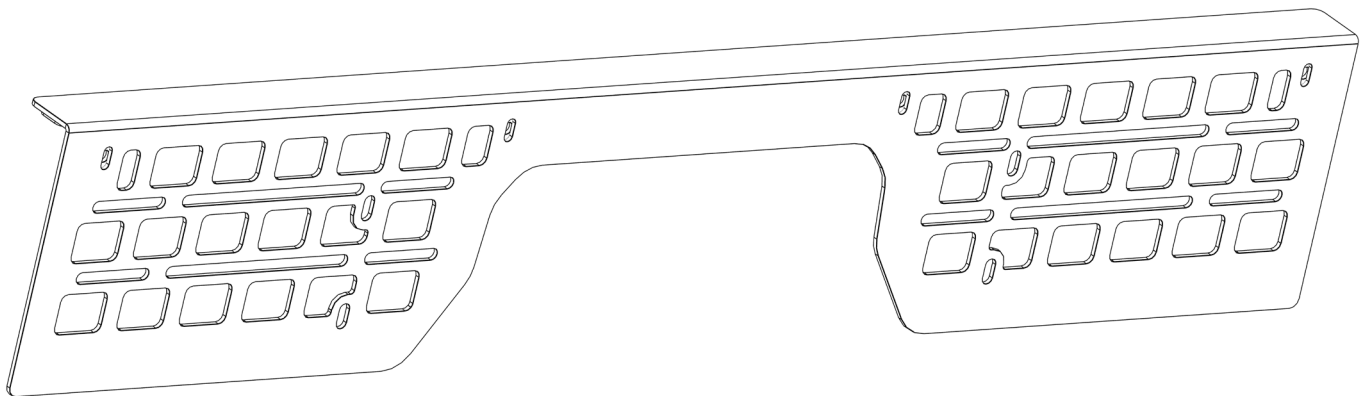

VICTORY 4X4

# TOYOTA TUNDRA 2022+ UNDER SEAT MOLLE

## INSTALL INSTRUCTIONS



**Please read the mounting instructions below carefully before attempting to install.**

**Be sure to check out the install video on the product page, if available.**

Thank you for purchasing from Victory 4x4! Checkout our website, [victory4x4.com](http://victory4x4.com) for other great off-road products. Be sure to rate and review our product online. If you have any questions or are missing parts, please don't hesitate to call us at 269-459-8447!

# INCLUDED HARDWARE

4x

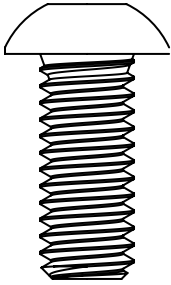

1/4"-20 Button Head

4x

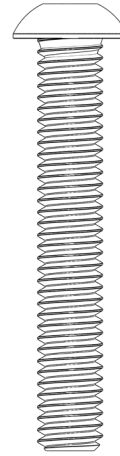

5/16"-18 Thread  
2" Long Stainless  
Steel Button Head

4x

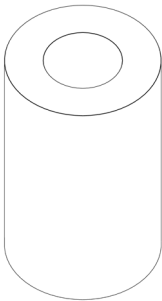

3/4" OD - 1-1/4" Long  
3/8" Screw Size  
Aluminium Spacer

4x

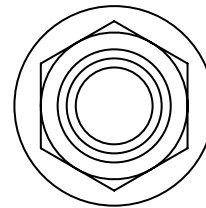

5/16"-18 Serr  
Flange Nut

# INCLUDED PARTS

1x



1x

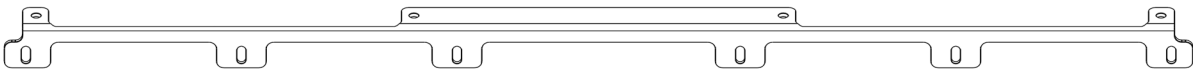

# INSTALLATION

- 1.** Start by folding your back seat up and remove any floor mats that you may have in the way in the back seat.
- 2.** Once the seats and floor mats are out of the way, you're going to want to remove the (6) factory clips that hold the front plastic cover of the under seat together. To do so, press down on the center until they pop and then use a pry tool or a flat head screw driver and pull stright up to remove them.



# INSTALLATION

3. With the clips removed, you can now pop out the plastic piece by pulling straight out. There will be (2) clips still holding it down that you won't be able to see, so you're going to have to use a good amount of force.



4. Take the smaller provided bracket and line up the (6) mounting holes on the top flange up with the holes where the clips use to be on the plastic and re-use the factory clips to secure the new bracket. Make sure to reset the clips before re-using them, to do so hold the top and push up on the bottom to pop the center cap back out, as shown below. Pull out on the center cap to extend it fully once it has popped up. Then simply push down on the center of the clip to to secure it once in the hole.



# INSTALLATION



5. With the bracket now in place and secure with the clips, you will need to remove the plastic cover for the fuse and relay on the passenger side, and the battery cover on the driver side. You can do so by using a plastic pry tool or a flat screw driver.



# INSTALLATION

6. Take the supplied molle panel and (4) of the supplied 5/16" -2" long button heads and nuts and (4) of the aluminum spacers and assemble them loose for now in the orientation shown below. Be sure to line the bolts up with the factory holes and make sure the nuts are behind the seat plastic. With the panels now removed from the previous step, you can now reach inside the seat to thread the nut onto the back of the bolts, as shown below.

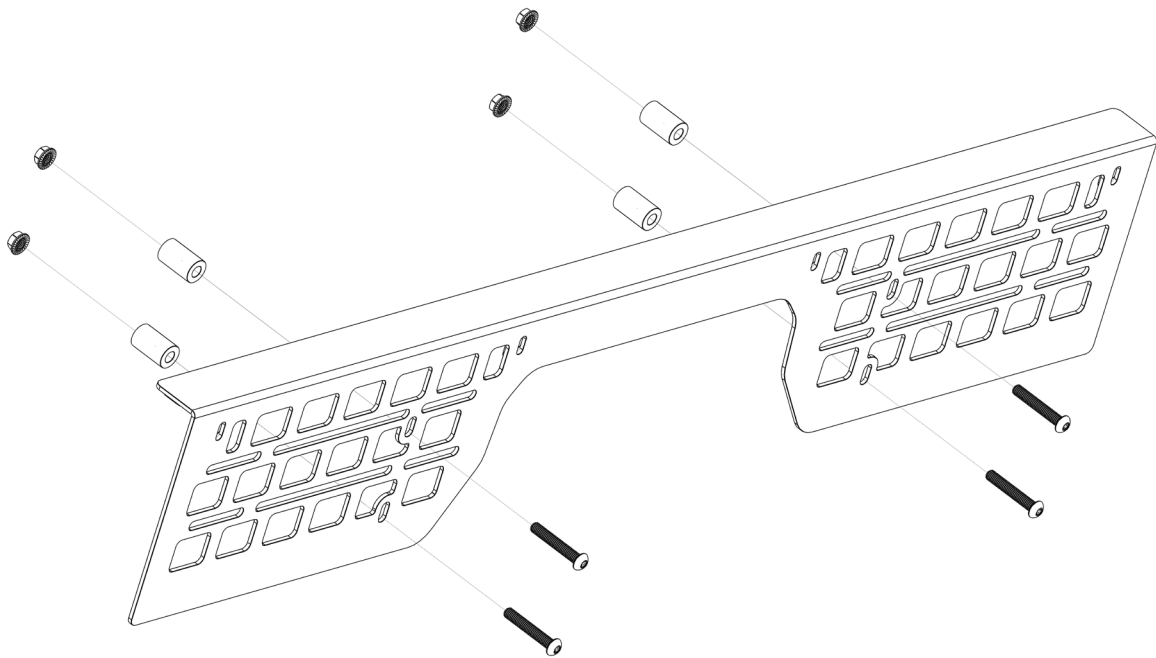

# INSTALLATION

7. Now that the molle panel is in place, take (4) of the supplied 1/4" button heads and thread them into the pre-existing nut holes on the mounting bracket through the slots on the molle panel, as shown below. Once you have all (4) bolts started you can tighten them down with 5/32" hex.

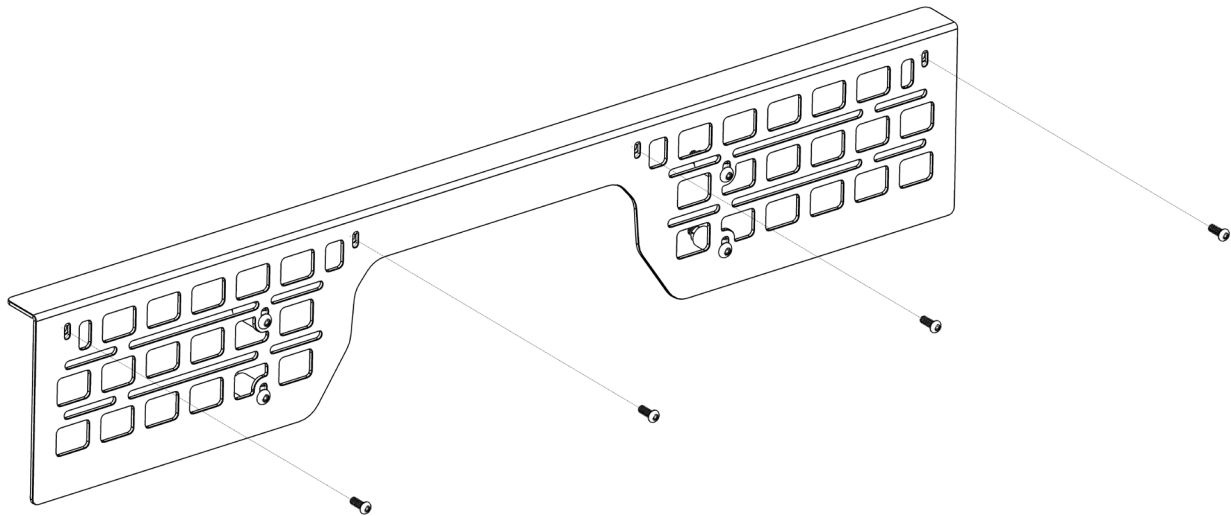

7. Go back and fully tighten the (4) longer 2" bolts with the spacers using a 3/16" hex. Now that you have all your hardware tight, reinstall the (2) plastic covers for the battery and fuse and relay box. Also reinstall any floor mats you may have had and flip the seats back down to complete your install.