



VICTORY  
4X4

# 3RD GEN TUNDRA BED STIFFENERS INSTALLATION INSTRUCTIONS

## TOOLS NEEDED

- 10mm Socket
- T55 Socket
- 1/2" Drill Bit
- 3/4" Socket and Ratchet

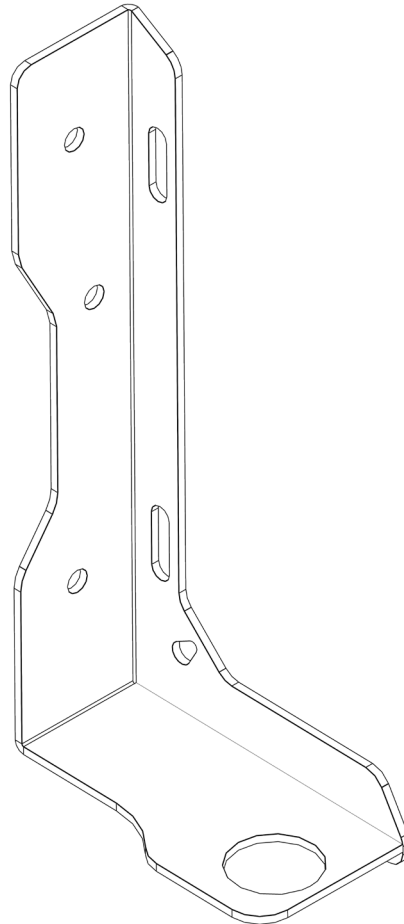

Please read the instructions below carefully before attempting to install.

# INCLUDED HARDWARE

6x

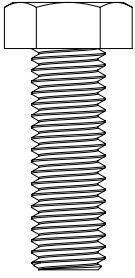

1/2"-13-1-1/2 Hex Head

12x

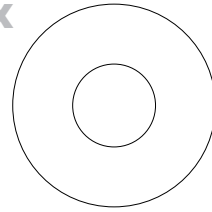

1/2" USS Flat Washer

6x

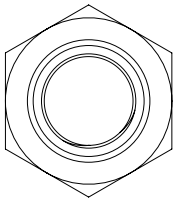

1/2"-13 Locknut

1. Using a 10mm socket, remove the 2 bolts holding the tail light in place. After you remove both bolts, pop out the tail light and unclip the factory wire harness and unplug the light from the harness.



2. Use a T55 socket to remove the factory bolt from the bed. You may need to remove the bedliner from the bolt before removing. Once you have the bolt removed, you can install your bracket in place by loosely securing the factory bolt back in, lining it up with the hole on the bracket.

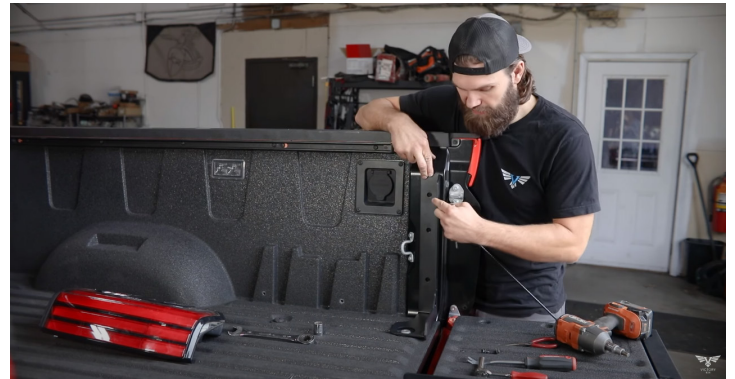

3. Using the bracket as a guide, either center punch the holes to mark your drill location or keep the bracket in place, making sure to keep it square and straight, and drill the holes into the bed using a 1/2" drill bit.

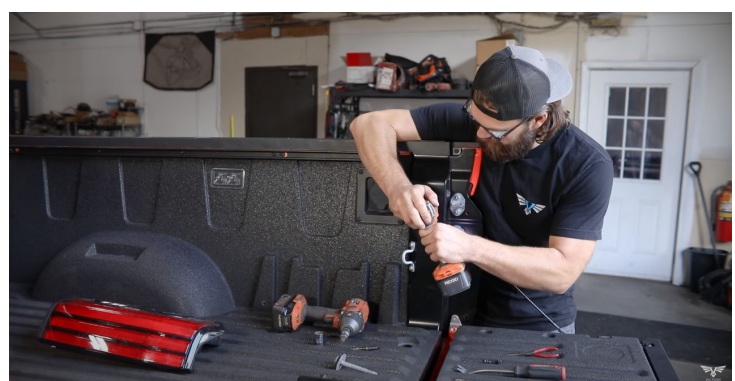

4. Once your holes are drilled, loosely secure your bracket back into the bed using the factory bolt. Then line up your holes in the bracket with the holes you just drilled into the bed and secure it with the supplied 1/2" hex bolt with the washers from the front and back, and reach through the tail light with the supplied 1/2" locknuts and tighten from the back.

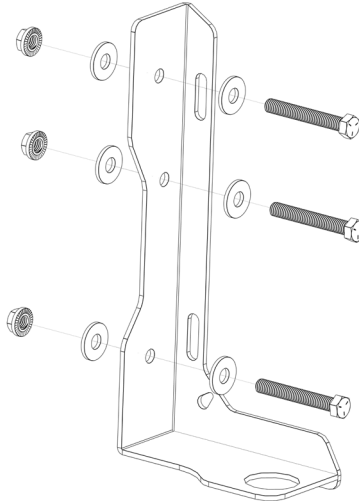

5. Once you have all your bolts loosely secured, then tighten all your hardware down with an impact. Then put your tail light clips back onto the tail light and plug it back in. Hook it back to the body and then secure the two 10mm bolts back in. Once you have done that your bed stiffeners are now fully installed.

