

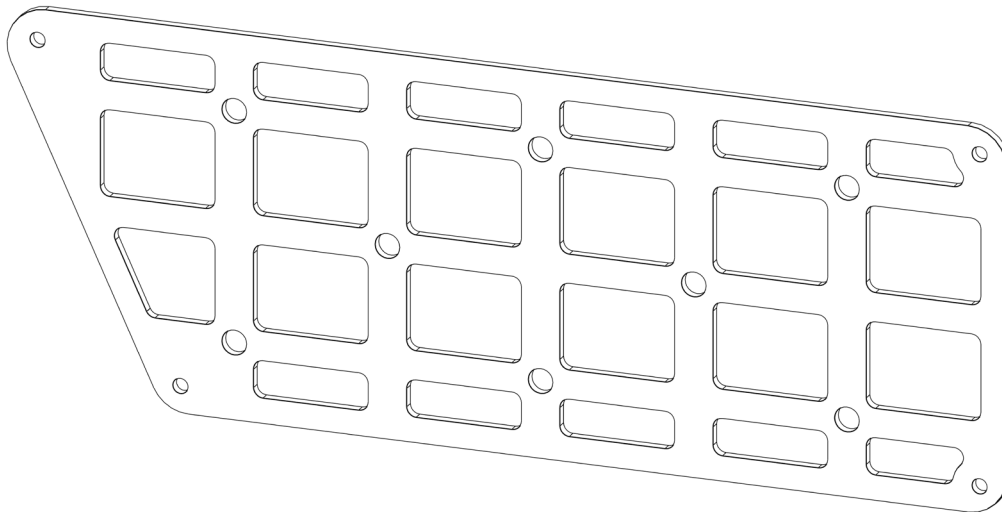

VICTORY 4X4

# 3RD GEN TUNDRA (14-21) DOOR MOLLE PANEL

## INSTALL INSTRUCTIONS



**Please read the mounting instructions below carefully before attempting to install.**

**Be sure to check out the install video on the product page, if available.**

Thank you for purchasing from Victory 4x4! Checkout our website, [victory4x4.com](http://victory4x4.com) for other great off-road products. Be sure to rate and review our product online. If you have any questions or are missing parts, please don't hesitate to call us at 269-459-8447!

# INCLUDED HARDWARE

8x

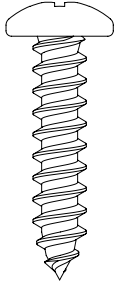

Black Philips Head  
18-8 Stainless Steel  
3/4" Long Screw

8x

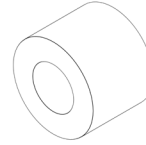

Black Nylon 1/2" OD  
3/8" Long Spacer

# INCLUDED PARTS

2x

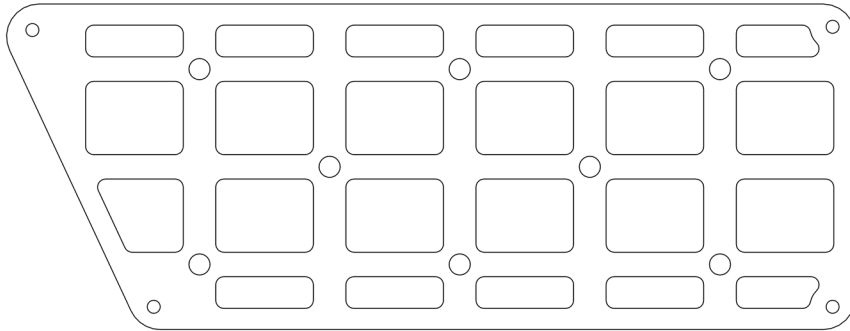

# INSTALLATION

- 1.** Start by lining up the panel up on you door in the area between the cubby and the arm rest, as shown below (driver side). When the panel is lined up to your liking, then take a punch or a philips head screw driver and apply pressure to mark the four smaller mounting holes in the plastic.



# INSTALLATION

- 2.** Once the pilot holes are marked, you can remove the panel. Take the provided screws and start to thread them in to the locations just marked. Make sure not to punch too far through the plastic. You can also use a drill with a 1/16" drill bit to start your holes, making sure not to punch through the plastic.
- 3.** After the holes are started, place the panel back in line with the holes and using the provided spacers, as shown below (driver side), start to thread the screws into the plastic with a screw driver until all four are snug and the panel is secur, be sure not to over tighten. Repeat this process for the other side.

